



# Einhell

CORDLESS EXCELLENCE.

**POWER X-CHANGE**



**2024  
FULL LINE  
CATALOGUE**





## INDEX BY ORDER OF CATAGORIES

### **Cordless Power Tools**

#### **Drilling/Driving- Kits & Bare Tools**

Cordless Drill/Drivers ..... 02-05

Cordless Hammer Drill/Driver ..... 05

#### **Impact Drivers/Wrenches- Kits & Bare Tools**

Cordless Impact Drivers ..... 06

Cordless Impact Wrenches ..... 07-08

#### **Hammer Drills- Bare Tools**

Cordless Hammer Drills ..... 09

Cordless SDS-Plus Rotary Hammers ..... 10

#### **Screw Gun- Bare Tool**

Cordless Drywall Screwdriver ..... 11

#### **Mortar/Grout Mixer- Bare Tool**

Motar/Grout Mixer ..... 11

#### **Saws- Bare Tools**

Cordless Circular Saws ..... 12

Cordless Reciprocating Saws ..... 13

Cordless Jigsaws ..... 14-15

Cordless Oscillating Multi-tools ..... 16

Cordless Table Saw ..... 17

#### **Tile Saw- Bare Tool**

Cordless Tile Saw ..... 17

#### **Sanders- Bare Tools**

Cordless Palm Detail Sander ..... 18

Cordless Random Orbit Sanders ..... 18-19

Cordless Belt Sanders ..... 19-20

#### **Drywall Sander- Bare Tool**

Cordless Drywall Sander ..... 20

#### **Angle Grinders- Bare Tools**

Cordless Angle Grinders ..... 21

#### **Polishers- Bare Tools**

Cordless Car Polisher ..... 22

Cordless Polisher/Sander ..... 22

#### **Specialty Tools- Bare Tools**

Cordless 18 Ga. Brad Nailer ..... 23

Cordless Drain Auger ..... 23

Cordless Compact Routers ..... 24

Cordless Portable Planer ..... 25

Cordless Biscuit Joiner ..... 25

Cordless Rotary Tool Station ..... 26

Cordless Heat Gun ..... 26

Cordless Full Size Glue Gun ..... 26

Cordless Handheld Paint Sprayer ..... 27

Cordless Caulk & Adhesive Gun ..... 27

#### **Vacuums/Wet-Dry Vacuums- Bare Tools**

Cordless Handheld Vacuum ..... 28

Cordless Stick Vacuum Cleaner ..... 28

Cordless Wet-Dry Vacuums ..... 29-30

Cordless Ash Vacuum ..... 30

#### **Air Movement- Bare Tools**

Cordless Compact Air Compressor ..... 31

Cordless Compact Blower ..... 31

Cordless Inflators ..... 32-33

Cordless Fan ..... 33

#### **LED Lights- Bare Tools**

Cordless LED Work Light ..... 34

Cordless Spotlight ..... 34

Cordless Hybrid LED Work Light ..... 35

#### **Practical Accessory- Bare Tool**

Cordless Bluetooth Speaker ..... 35

#### **E-Cases**

E-Case Tool Cases ..... 36

### **Cordless Outdoor Power Equipment**

#### **Lawn Mower Kits with Batteries and Chargers**

Cordless Lawn Mower Kits ..... 38-39

#### **String Trimmers- Kits and Bare Tools**

Cordless Stringless Blade Trimmer ..... 39

Cordless String Trimmers ..... 40-41

#### **Hedge Trimmers- Kits and Bare Tools**

Cordless Hedge Trimmers ..... 41-42

#### **Pole Hedge Trimmer- Pole Chain Saw- Bare Tools**

Cordless Pole Hedge Trimmer ..... 43

Cordless Pole Chain Saw ..... 43

### **Multi-Attachment Tools- Combos- Bare Tools**

Cordless 2-in-1 Combo ..... 44

Cordless 4-in-1 Combo ..... 44

#### **Pruning/Shrub Shears- Bare Tools**

Cordless Pruning Shear ..... 45

Cordless Grass Shear & Hedge Trimmer ..... 45

#### **Chain Saws- Kits and Bare Tools**

Cordless Compact Pruning Chain Saw ..... 46

Cordless Chain Saws ..... 47-48

#### **Leaf Blowers/Vacuums/Mulchers- Kits /Bare Tools**

Cordless Leaf Blowers ..... 48-49

Cordless Leaf/Vacuum/Mulchers ..... 50

#### **Chipper/Shredder- Bare Tool**

Cordless Chipper/Shredder ..... 51

#### **Tiller/Cultivator- Bare Tool**

Cordless Tiller/Cultivator ..... 51

#### **Auger/Mixer/Ice Auger- Bare Tool**

Cordless Auger ..... 52

#### **Seed/Fertilizer/Salt Spreader- Bare Tools**

Cordless Universal Spreader ..... 53

Cordless Multi-purpose Spreader ..... 53

#### **Chemical/Pressure Sprayers- Bare Tools**

Cordless Chemical Sprayer ..... 54

Cordless Pressure Sprayer ..... 54

#### **Water Hose Reel & Trolley- Bare Tool**

Cordless Water Hose Reel ..... 55

#### **Pressure Washer- Bare Tool**

Cordless Pressure Washer ..... 56

#### **Water/Garden Pump- Bare Tool**

Cordless Water Pump ..... 56

#### **Batteries, Chargers, Battery Starter Kits & Accessories**

Batteries ..... 57

Chargers ..... 57

Battery Starter Kits ..... 57

Cordless USB Battery Adaptor ..... 57

Cordless PXC Battery Wall Mounts ..... 57

## INDEX BY ALPHANUMERIC ORDER

2070120.....	32
2071020.....	32
2093303.....	22
2093325.....	22
2347124.....	28
2347137.....	29
2347141.....	30
2347165.....	29
2347184.....	28
2361701.....	30
3408005.....	31
3408036.....	33
3408304.....	45
3410314.....	45
3410583.....	43
3410584.....	43
3410709.....	41
3410789.....	44
3410923.....	42
3410963.....	42
3411126.....	39
3411245.....	40
3411260.....	40
3411295.....	41
3411325.....	44
3413273.....	38
3413298.....	38
3413322.....	39
3415411.....	53
3415440.....	53
3425221.....	54
3425231.....	54
3430730.....	51
3431205.....	51
3433543.....	48
3433556.....	49
3433617.....	49
3433645.....	50
3433647.....	50
3437015.....	52
4020455.....	31
4020463.....	33
4140145.....	56
4173779.....	55
4173780.....	55
4180403.....	56
4257245.....	03
4257796.....	23
4258765.....	11
4259985.....	11
4259992.....	20
4260027.....	27
4301191.....	17
4321233.....	14
4321235.....	14
4321263.....	15
4321267.....	15
4326307.....	13
4326311.....	13
4331211.....	12
4331215.....	12
4340451.....	17
4345401.....	25
4350413.....	24
4350415.....	24
4350631.....	25
4419370.....	26
4431122.....	21
4431143.....	21
4431147.....	21
4460721.....	18
4461010.....	19
4462012.....	18
4462021.....	19
4465165.....	16
4465191.....	16
4466271.....	20
4501781.....	48
4501786.....	47
4510045.....	07
4510060.....	06
4510062.....	07
4510064.....	06
4510071.....	08
4510081.....	08
4513893.....	05
4513906.....	10
4513928.....	02
4513937.....	09
4513945.....	02
4513961.....	09
4513977.....	10
4513979.....	03
4514135.....	34
4514137.....	35
4514142.....	57
4514146.....	34
4514151.....	35
4514156.....	57
4514165.....	23
4514350.....	04
4514351.....	04
4514360.....	05
4520502.....	26
4522201.....	26
4522251.....	27
4540022.....	36
4540023.....	36
4540024.....	36
4600015.....	47
4600030.....	46
4600035.....	46



**POWER X-CHANGE**

***CORDLESS  
POWER TOOLS***





## Drilling & Driving - Kits & Bare Tools

### 18V 3/8" Cordless Drill Driver Kit (w/ 2.0 Ah Battery and Charger)

Article No. **4513928**

TC-CD 18/35 Li Kit

UPC 7-72995-01962-5

**CLASSIC**

**POWER X-CHANGE**



#### Features

- Electronic speed controller for work adapted to application
- LED light for optimum operation in dark areas
- Extremely easy to work with due to ergonomic design and softgrip
- Comes with 2.0 Ah battery and charger

#### Technical Data

- Battery 18V | 2.0 Ah | Li-Ion
- Number of gears 1
- Variable speed range (gear 1) 0 - 550 RPM
- Max. torque 310 in/lbs (35 Nm)
- Number of torque steps 21 settings
- Drill chuck 3/8" | double sleeve
- Product weight 3 lbs

#### Standard Accessories

- 1 x 2.0 Ah Power X-Change battery & charger



2.0 Ah	2.5 Ah	4.0 Ah	5.2 Ah	6.0 Ah	8.0 Ah
Up to 295 screws	Up to 366 screws	Up to 590 screws	Up to 760 screws	Up to 880 screws	Up to 1180 screws

2-3/8" wood screws

## Drilling & Driving - Kits & Bare Tools

### 18V 1/2" Cordless Drill Driver

Article No. **4513945**

TE-CD 18/40 Li-i-Solo

UPC 7-72995-01752-2

**EXPERT**

**POWER X-CHANGE**



#### Features

- Practical belt clip for efficient and safe operation
- 2-speed gearing for powerful drilling and screwing
- Electronic speed controller for work adapted to application
- Always ready-for-use due to Li-Ion technology without discharging
- Complete with LED lamp to illuminate the work area
- Extremely easy to work with due to ergonomic design and softgrip surfaces
- Recommended for maximum results: 2.0 or 2.5 Ah battery
- Battery and charger sold separately

#### Technical Data

- Number of gears 2
- Idle speed (gear 1) 0 - 400 RPM
- Idle speed (gear 2) 0 - 1,500 RPM
- Max. torque 354 in/lbs (40 Nm)
- Number of torque steps 21 settings
- Drill chuck 1/2" | single sleeve
- Product weight 2.42 lbs



2.0 Ah	2.5 Ah	4.0 Ah	5.2 Ah	6.0 Ah	8.0 Ah
Up to 305 screws	Up to 380 screws	Up to 610 screws	Up to 770 screws	Up to 920 screws	Up to 1220 screws

2-3/8" wood screws



## Drilling & Driving - Kits & Bare Tools

### 18V 1/2" Cordless Drill Driver Kit (w/ 2 x 2.0 Ah Batteries, Charger & Case)

Article No. **4513979**

**TE-CD 18/40-1 Li (2x2.0Ah)**

UPC 7-72995-01753-9

**EXPERT**

**POWER X-CHANGE**



#### Features

- 2-speed gearing for powerful drilling and screwing
- Practical belt clip for efficient and safe operation
- Complete with LED lamp to illuminate the work area
- Extremely easy to work with ergonomic design and softgrip surfaces
- Comes with 2 x 2.0 Ah batteries, 30 minute charger and carry case

#### Technical Data

- Battery 18V | 2.0 Ah | Li-Ion
- Number of gears 2
- Idle speed (gear 1) 0 - 400 RPM
- Idle speed (gear 2) 0 - 1,500 RPM
- Max. torque 354 in/lbs (40 Nm)
- Number of torque steps 21 settings
- Drill chuck 1/2" | single sleeve
- Product weight 4.84 lbs

#### Standard Accessories

- 2 x 2.0 Ah Power X-Change batteries
- 30 minute charger
- Carry case



2.0 Ah	2.5 Ah	4.0 Ah	5.2 Ah	6.0 Ah	8.0 Ah
Up to 305 screws	Up to 380 screws	Up to 610 screws	Up to 770 screws	Up to 920 screws	Up to 1220 screws

2-3/8" wood screws

## Drilling & Driving - Kits & Bare Tools

### 18V Cordless 1/2" Drill/Driver & 1/4" Impact Kit (w/ 2x 2.0 Ah Batteries, Charger & Carry Bag)

Article No. **4257245**

**TE-TK 18 Li Kit**

UPC 7-72995-01754-6

**EXPERT**

**POWER X-CHANGE**



#### Features- 4513945

- 2-speed gearing for powerful drilling and screwing
- Complete with LED lamp to illuminate the work area
- Practical belt clip for efficient and safe operation
- Ergonomic design and softgrip surfaces
- Recommended for maximum results: 2.0 or 2.5 Ah battery

#### Features- 4510060

- Hammer screwdriver – for effortlessly tightening large/long screw
- Low reverse torque reduces strain on the wrists during operation
- Short, lightweight design with ergonomic softgrip surfaces
- 1/4" hex. bit (Recommendation: impact-resistant bits)
- Speed control for fine adjustment on delicate jobs
- 3 powerful LED to illuminate the work area
- Rugged aluminum housing and rubber supports for protection
- Recommended battery for maximum results: 2.0 or 2.5 Ah battery

#### Standard Accessories

- 2 x 2.0 Ah Power X-Change battery
- 30 minute charger
- Carry bag



2.0 Ah	2.5 Ah	4.0 Ah	5.2 Ah	6.0 Ah	8.0 Ah
Up to 305 screws	Up to 380 screws	Up to 610 screws	Up to 770 screws	Up to 920 screws	Up to 1220 screws

4513945 - 2-3/8" wood screws

2.0 Ah	2.5 Ah	4.0 Ah	5.2 Ah	6.0 Ah	8.0 Ah
Up to 185 nuts	Up to 230 nuts	Up to 370 nuts	Up to 520 nuts	Up to 560 nuts	Up to 740 nuts

4510060 - wheel nuts

## 18V 3/8" Cordless Drill Driver - Brushless

Article No. **4514350**

TE-CD 18/40 Li BL

UPC 7-72995-01914-4

**EXPERT**

**POWER X-CHANGE**



### Features

- Brushless motor – more power and longer runtimes
- High-grade and single sleeve chuck
- 2-speed gearing for powerful drilling and screwing
- Electronic speed controller for work adapted to application
- LED light for optimum operation in dark areas
- Extremely easy to work with due to ergonomic design and softgrip
- Small and light weight cordless drill for working without fatigue
- Recommended for maximum results: 2.5 Ah battery
- Battery and charger sold separately

### Technical Data

- Number of gears 2
- Idle speed (gear 1) 0 - 350 RPM
- Idle speed (gear 2) 0 - 1,450 RPM
- Max. torque 354 in/lbs (40 Nm)
- Number of torque steps 20 + 1
- Drill chuck 3/8" | single sleeve
- Product weight 1.76 lbs

**PUREPOWER**  
BRUSHLESS



2.0 Ah	2.5 Ah	4.0 Ah	5.2 Ah	6.0 Ah	8.0 Ah
Up to 300 screws	Up to 380 screws	Up to 600 screws	Up to 780 screws	Up to 900 screws	Up to 1200 screws

2-3/8" wood screws

## 18V 3/8" Cordless Drill Driver Kit - Brushless (w/ 2x 2.0 Ah Batteries, Charger & Carry Case)

Article No. **4514351**

TE-CD 18/40 Li BL Kit

UPC 7-72995-01915-1

**EXPERT**

**POWER X-CHANGE**



### Features

- Brushless motor – more power and longer runtimes
- 2-speed gearing for powerful drilling and screwing
- Electronic speed control to suit material and application
- LED light for optimum operation in dark areas
- Extremely easy to work with due to ergonomic design and softgrip
- Comes with 2 x 2.0 Ah batteries, charger and carrying case

### Technical Data

- Battery 18V | 2.0 Ah | Li-Ion
- Number of gears 2
- Idle speed (gear 1) 0 - 350 RPM
- Idle speed (gear 2) 0 - 1,450 RPM
- Max. torque hard 354 in/lbs (40 Nm)
- Number of torque steps 20 + 1
- Drill chuck 3/8" | single sleeve
- Product weight 1.76 lbs

### Standard Accessories

- 2 x 2.0 Ah Power X-Change batteries
- 30 minute charger
- Carry case

**PUREPOWER**  
BRUSHLESS



2.0 Ah	2.5 Ah	4.0 Ah	5.2 Ah	6.0 Ah	8.0 Ah
Up to 300 screws	Up to 380 screws	Up to 600 screws	Up to 780 screws	Up to 900 screws	Up to 1200 screws

2-3/8" wood screws



## 18V 1/2" Cordless Drill Driver - Brushless

Article No. **4513893**

TP-CD 18 Li-BL-Solo

UPC 7-72995-01755-3

**PROFESSIONAL**

**POWER X-CHANGE**



### Features

- Brushless motor - more power and longer runtimes
- High-grade 1/2" metal drill chuck
- Practical belt clip for efficient and safe operation
- 2-speed gearing for powerful driving and fast drilling
- Quick-stop for changing tools quickly and easily
- Ergonomic design with softgrip surfaces
- Less strain on the joints during operation thanks to additional handle
- Complete with LED lamp to illuminate the work area
- Recommended for maximum results: 2.0 or 2.5 Ah battery
- Battery and charger sold separately

### Technical Data

- |                          |                      |
|--------------------------|----------------------|
| • Number of gears        | 2                    |
| • Idle speed (gear 1)    | 0 - 500 RPM          |
| • Idle speed (gear 2)    | 0 - 1,800 RPM        |
| • Max. torque            | 531 in/lbs (60 Nm)   |
| • Number of torque steps | 20 settings          |
| • Drill chuck            | 1/2"   single sleeve |
| • Product weight         | 2.86 lbs             |

**PUREPOWER**  
BRUSHLESS



2.0 Ah	2.5 Ah	4.0 Ah	5.2 Ah	6.0 Ah	8.0 Ah
Up to 350 screws	Up to 440 screws	Up to 700 screws	Up to 920 screws	Up to 1060 screws	Up to 1410 screws

2-3/8" wood screws

## 18V 1/2" Cordless Hammer Drill/Driver Kit - Brushless (w/ 2x 2.0 Ah Batteries, Charger & Carry Case)

Article No. **4514360**

TP-CD 18/50 Li-i BL Kit

UPC 7-72995-01920-5

**PROFESSIONAL**

**POWER X-CHANGE**



### Features

- Brushless motor - more power and longer runtimes
- Impact drilling function for universal operation
- High-grade 1/2" metal drill chuck
- 2-speed gearbox for powerful drilling and screwing
- Electronic speed control to suit material and application
- LED light for optimum operation in dark areas
- Extremely easy to work with due to ergonomic design and softgrip
- Comes with 2 x 2.0 Ah batteries, charger and carrying case

### Technical Data

- |                          |                       |
|--------------------------|-----------------------|
| • Battery                | 18V   2.0 Ah   Li-Ion |
| • Number of gears        | 2                     |
| • Idle speed (gear 1)    | 0 - 500 RPM           |
| • Idle speed (gear 2)    | 0 - 1,800 RPM         |
| • Hammer speed (gear 1)  | 0 - 8,000 BPM         |
| • Hammer speed (gear 2)  | 0 - 28,800 BPM        |
| • Max. torque            | 443 in/lbs (50 Nm)    |
| • Number of torque steps | 21 settings           |
| • Drill chuck            | 1/2"   single sleeve  |
| • Product weight         | 2.6 lbs               |

### Standard Accessories

- 2 x 2.0 Ah Power X-Change battery & charger
- Carry case

**PUREPOWER**  
BRUSHLESS



2.0 Ah	2.5 Ah	4.0 Ah	5.2 Ah	6.0 Ah	8.0 Ah
Up to 320 screws	Up to 400 screws	Up to 640 screws	Up to 830 screws	Up to 960 screws	Up to 1280 screws

2-3/8" wood screws

## Impact Drivers / Wrenches - Kits & Bare Tools

### 18V 1/4" Cordless Impact Driver

Article No. **4510060**

TE-CI 18/1 Li-Solo

UPC 7-72995-01757-7

**EXPERT**

**POWER X-CHANGE**



#### Features

- Practical belt clip for efficient and safe operation
- Hammer screwdriver – for effortlessly tightening large/long screw
- Low reverse torque reduces strain on the wrists during operation
- Short, lightweight design with ergonomic softgrip surfaces
- Speed control for fine adjustment on delicate jobs
- 3 powerful LED included for good all round illumination
- Rugged aluminum housing and rubber supports for protection
- Recommended battery for maximum results: 2.0 or 2.5 Ah battery
- Battery and charger sold separately

#### Technical Data

- |                         |                         |
|-------------------------|-------------------------|
| • No load speed         | 0 - 2,300 RPM           |
| • Impacts per minute    | 0 - 2,900 IPM           |
| • Tool collet (hex.)    | 1/4"                    |
| • Type of bit interlock | Mechanic locking sleeve |
| • Max. torque           | 1,240 in/lbs (140 Nm)   |
| • Product weight        | 2.57 lbs                |

**1240**  
in-lbs  
**HIGH**  
**POWER**

**1/4"**

**0-2300**  
**RPM**  
REVOLUTIONS  
PER MINUTE

**0-2900**  
**IPM**  
IMPACTS  
PER MINUTE



2.0 Ah	2.5 Ah	4.0 Ah	5.2 Ah	6.0 Ah	8.0 Ah
Up to 185 nuts	Up to 230 nuts	Up to 370 nuts	Up to 520 nuts	Up to 560 nuts	Up to 740 nuts

Wheel nuts

## Impact Drivers / Wrenches - Kits & Bare Tools

### 18V 1/4" Cordless Impact Driver Kit (w/ 2.0 Ah Battery, Charger & Soft Bag)

Article No. **4510064**

TE-CI 18/1 Li Kit SB

UPC 7-72995-01979-3

**EXPERT**

**POWER X-CHANGE**



#### Features

- Practical belt clip for efficient and safe operation
- Hammer screwdriver – for effortlessly tightening large/long screws
- Low reverse torque reduces strain on the wrists during operation
- Short, lightweight design with ergonomic softgrip surfaces
- 1/4" hex. bit (Recommendation: impact-resistant bits)
- Speed control for fine adjustment on delicate jobs
- 3 powerful LED included for good all round illumination
- Rugged aluminum housing and rubber supports for protection
- Comes with 2.0 Ah battery, charger and soft bag

#### Technical Data

- |                         |                         |
|-------------------------|-------------------------|
| • Battery               | 18V   2.0 Ah   Li-Ion   |
| • No load speed         | 0 - 2,300 RPM           |
| • Impacts per minute    | 0 - 2,900 IPM           |
| • Tool collet (hex.)    | 1/4"                    |
| • Type of bit interlock | Mechanic locking sleeve |
| • Max. torque           | 1,240 in/lbs (140 Nm)   |
| • Product weight        | 3.4 lbs                 |

#### Standard Accessories

- 2.0 Ah Power X-Change battery & charger
- Soft bag

**1240**  
in-lbs  
**HIGH**  
**POWER**

**1/4"**



2.0 Ah	2.5 Ah	4.0 Ah	5.2 Ah	6.0 Ah	8.0 Ah
Up to 185 nuts	Up to 230 nuts	Up to 370 nuts	Up to 520 nuts	Up to 560 nuts	Up to 740 nuts

Wheel nuts



## Impact Drivers / Wrenches - Kits & Bare Tools

### 18V 1/4" Cordless Impact Driver - Brushless

Article No. **4510045**

TP-CI 18 Li BL-Solo

UPC 7-72995-01758-4

**PROFESSIONAL**

**POWER X-CHANGE**



#### Features

- Brushless motor - more power and longer runtimes
- Practical belt clip for efficient and safe operation
- Impact driver-for effortless tightening of large/long screws
- 1/4" hex. bit (Recommendation: impact-resistant bits)
- Speed control for fine adjustment on delicate jobs
- Short, lightweight design with ergonomic softgrip surfaces
- Special impact mechanism protects the wrist from torsional forces
- 3 powerful LED to illuminate the work area
- Recommended battery for maximum results: 2.0 or 2.5 Ah battery
- Battery and charger sold separately

#### Technical Data

- No load speed 0 - 2,900 RPM
- Impacts per minute 0 - 3,000 IPM
- Type of bit interlock Mechanic locking sleeve
- Tool collet (hex.) 1/4"
- Max. torque 1,594 in/lbs (180 Nm)
- Product weight 2.35 lbs

**PUREPOWER**  
BRUSHLESS

**1594**  
in-lbs  
**HIGH POWER**

**1/4"**

**0-2900**  
**RPM**  
REVOLUTIONS  
PER MINUTE

**BEST**  
PERFORMANCE  
WITH  
**≥ 2.5 Ah**



2.0 Ah	2.5 Ah	4.0 Ah	5.2 Ah	6.0 Ah	8.0 Ah
Up to 280 nuts	Up to 350 nuts	Up to 560 nuts	Up to 730 nuts	Up to 840 nuts	Up to 1120 nuts

Wheel nuts

## Impact Drivers / Wrenches - Kits & Bare Tools

### 18V 1/2" Cordless Impact Wrench & Driver - Brushless

Article No. **4510062**

TP-CW 18 Li-Solo

UPC 7-72995-01756-0

**PROFESSIONAL**

**POWER X-CHANGE**



#### Features

- Brushless motor - more power and longer runtimes
- Powerful high-torque cordless impact wrench
- Practical belt clip for efficient and safe operation
- Small and light - for comfortable operation
- Robust 1/2" external square drive mount
- Ergonomic softgrip surfaces
- Complete with 1/4" bit adapter for screw driving
- Complete with 3 LED to illuminate the work area
- Recommended battery for maximum results: 2.0 or 2.5 Ah battery
- Battery and charger sold separately

#### Technical Data

- No load speed 0 - 2,900 RPM
- Impacts per minute 0 - 3,000 IPM
- Tool collet (square) 1/2"
- Tool collet (hex.) 1/4"
- Max. torque 1,770 in/lbs (200 Nm)
- Product weight 2.42 lbs

**PUREPOWER**  
BRUSHLESS

**1770**  
in-lbs  
**HIGH POWER**

**1/2"**

**0-2900**  
**RPM**  
REVOLUTIONS  
PER MINUTE

**1/2"**



2.0 Ah	2.5 Ah	4.0 Ah	5.2 Ah	6.0 Ah	8.0 Ah
Up to 100 nuts	Up to 125 nuts	Up to 200 nuts	Up to 260 nuts	Up to 300 nuts	Up to 400 nuts

Wheel nuts

## Impact Drivers / Wrenches - Kits & Bare Tools

### 18V 1/2" Cordless Impact Wrench - Brushless

Article No. **4510081**

**IMPAXXO 18/230**

UPC 7-72995-01906-9

**PROFESSIONAL**

**POWER X-CHANGE**



#### Features

- Brushless motor - more power and longer runtimes
- High-torque cordless impact wrench for releasing wheel nuts
- Robust 1/2" external square drive mount
- Special impact mechanism protects the wrists from twisting forces
- Robust gear housing for a longer lifetime
- Electronic speed control to suit material and application
- Complete with LED light to illuminate the work area
- Belt clip for safe keeping during working breaks
- Ergonomic design and softgrip for more grip while working
- Complete with a 1/4" bit adapter for fixing bits for screws
- Recommended battery for maximum results: 2.5 Ah battery
- Battery and charger sold separately

#### Technical Data

- No load speed 0 - 2,900 RPM
- Impacts per minute 0 - 3,000 IPM
- Tool collet (square) 1/2"
- Max. torque 2,036 in/lbs (230Nm)
- Product weight 3.4 lbs

**PUREPOWER**  
BRUSHLESS

**2036**  
in-lbs  
**HIGH POWER**



**0-2900**  
**RPM**  
REVOLUTIONS  
PER MINUTE



**1/2"**



2.0 Ah	2.5 Ah	4.0 Ah	5.2 Ah	6.0 Ah	8.0 Ah
Up to 100 nuts	Up to 125 nuts	Up to 200 nuts	Up to 260 nuts	Up to 300 nuts	Up to 400 nuts

Wheel nuts

## Impact Drivers / Wrenches - Kits & Bare Tools

### 18V 1/2" Cordless Impact Wrench - Brushless

Article No. **4510071**

**IMPAXXO 18/400**

UPC 7-72995-01905-2

**PROFESSIONAL**

**POWER X-CHANGE**



#### Features

- Brushless motor - more power and longer runtimes
- Very high torque for easy loosening of wheel nuts
- Robust 1/2" external square drive mount
- LED light to illuminate the work area
- 3 speed settings for a perfect speed adjustment
- Complete with 1/4" bit adapter for screw driving
- Complete with a 3 pc. socket set for car wheel changing (sizes: 17, 19, 21mm)
- Recommended battery for maximum results: 2.5 Ah battery
- Battery and charger sold separately

#### Technical Data

- Number of gears 3
- No load speed 0 - 2,100 RPM
- Impacts per minute 0 - 3,300 IPM
- Tool collet (square) 1/2"
- Max. torque 3,540 in/lbs (400 Nm)
- Product weight 4.4 lbs

#### Standard Accessories

- Bit adaptor (1/4")
- 3 impact sockets (17, 19, 21mm)

**PUREPOWER**  
BRUSHLESS

**3540**  
in-lbs  
**HIGH POWER**

**3**  
**SPEED SETTINGS**

**0-2100**  
**RPM**  
REVOLUTIONS  
PER MINUTE

**0-3300**  
**IPM**  
IMPACTS  
PER MINUTE



2.0 Ah	2.5 Ah	4.0 Ah	5.2 Ah	6.0 Ah	8.0 Ah
Up to 55 nuts	Up to 70 nuts	Up to 110 nuts	Up to 140 nuts	Up to 170 nuts	Up to 220 nuts

Wheel nuts



## Hammer Drills - Kits & Bare Tools

### 18V 1/2" Cordless Hammer Drill

Article No. **4513961**

TC-ID 18 Li-Solo

UPC 7-72995-01750-8

**CLASSIC**

**POWER X-CHANGE**



#### Features

- 2 functions: Drilling/impact drilling
- Rugged 1/2" quick-change drill chuck for easy tool change
- Electronic speed control for fine adjustment
- Ergonomic softgrip surfaces with additional handle
- Reverse function for drilling and screwing
- Continuous operation lock for comfortable and easy operation
- Infinitely adjustable drilling depth stop made of solid metal
- Recommended battery for maximum results: 2.0 or 2.5 Ah battery
- Battery and charger sold separately

#### Technical Data

- No load speed 0 - 2,600 RPM
- Hammer speed 41,600 BPM
- Drilling capacity (wood) 1"
- Drilling capacity (concrete) 1/2"
- Drilling capacity (metal) 3/8"
- Drill chuck 1/2" | single sleeve
- Product weight 3.52 lbs



2.0 Ah	2.5 Ah	4.0 Ah	5.2 Ah	6.0 Ah	8.0 Ah
Up to 60 holes	Up to 75 holes	Up to 120 holes	Up to 156 holes	Up to 180 holes	Up to 240 holes

1/4" x 1-3/4" long holes in red brick

## Hammer Drills - Kits & Bare Tools

### 18V 1/2" Cordless Hammer Drill/Driver

Article No. **4513937**

TE-CD 18/48 Li-i-Solo

UPC 7-72995-01751-5

**EXPERT**

**POWER X-CHANGE**



#### Features

- Impact drilling function for universal operation
- 2-speed gearing for powerful drilling and screwing
- Practical belt clip for efficient and safe operation
- Complete with LED lamp to illuminate work area
- Extremely easy to work with ergonomic design and softgrip surfaces
- Recommended battery for maximum results: 2.0 or 2.5 Ah battery
- Battery and charger sold separately

#### Technical Data

- Number of gears 2
- Idle speed (gear 1) 0 - 400 RPM
- Idle speed (gear 2) 0 - 1,500 RPM
- Hammer speed (gear 1) 0 - 6,400 BPM
- Hammer speed (gear 2) 0 - 24,000 BPM
- Max. torque 390 in/lbs (44 Nm)
- Number of torque steps 23 settings
- Drill chuck 1/2" | single sleeve
- Drilling capacity in concrete 13/32"
- Product weight 3.1 lbs



2.0 Ah	2.5 Ah	4.0 Ah	5.2 Ah	6.0 Ah	8.0 Ah
Up to 310 screws	Up to 380 screws	Up to 620 screws	Up to 780 screws	Up to 910 screws	Up to 1230 screws

2-3/8" wood crews

## Hammer Drills - Bare Tools

### 18V 3/4" SDS-Plus Cordless Rotary Hammer - Brushless

Article No. **4513906**

**HEROCCO 18/20**

UPC 7-72995-01760-7

**PROFESSIONAL**

**POWER X-CHANGE**



#### Features

- Brushless motor - more power and longer runtimes
- 4+1 functions: Drilling/impact drilling/chiseling with & w/o lock
- Pneumatic impact mechanism for effortless drilling in concrete
- Universal SDS-plus chuck with semi-automatic function
- Speed electronics for fine adjustment on delicate jobs
- Low-vibration operations by vibration-cushioned main handle
- Ergonomic softgrip surfaces with additional handle
- Infinitely adjustable drilling depth stop made of solid metal
- Comes with LED lamp to illuminate the work area
- Magnetic bit adapter for screwing
- Supplied with E-Box case
- Recommended battery for maximum results: 4.0 Ah battery
- Battery and charger sold separately

#### Technical Data

- |                                 |               |
|---------------------------------|---------------|
| • No load speed                 | 0 - 1,200 RPM |
| • Hammer speed                  | 0 - 5,500 BPM |
| • Impact power                  | 1.6 ft/lbs    |
| • Drilling capacity in concrete | 3/4"          |
| • Product weight                | 4.66 lbs      |

**PUREPOWER**  
BRUSHLESS

**1.6**  
ft-lb



2.0 Ah	2.5 Ah	4.0 Ah	5.2 Ah	6.0 Ah	8.0 Ah
Up to 335 holes	Up to 417 holes	Up to 670 holes	Up to 870 holes	Up to 1000 holes	Up to 1330 holes

1/4" x 1-15/16" long holes in red brick

## Hammer Drills - Bare Tools

### 36V 1" SDS-Plus Cordless Rotary Hammer - Brushless

Article No. **4513977**

**HEROCCO 36/28**

UPC 7-72995-01875-8

**PROFESSIONAL**

**POWER X-CHANGE**



#### Features

- Brushless motor - more power and longer runtimes
- TWIN-PACK technology: 2 x 18V Power X-Change batteries required
- High drilling performance with cordless freedom
- 4 functions: Drilling/impact drilling/chiseling with and w/o lock
- Overload safety stop for extra user safety
- Universal SDS-Plus chuck with semi-automatic function
- Electronic speed controller for fine adjustment on delicate jobs
- Low-vibration operations by vibration-cushioned main handle
- Ergonomic handle and additional handle with softgrip
- Adjustable drilling depth stop made of solid metal
- Comes with LED light to illuminate the work area
- Supplied with E-Box case
- Recommended for maximum results: 2 x 4.0 Ah batteries
- Batteries and charger sold separately

#### Technical Data

- |                                 |               |
|---------------------------------|---------------|
| • Battery                       | 36V (2 x 18V) |
| • No load speed                 | 0 - 1,100 RPM |
| • Hammer speed                  | 0 - 5,300 BPM |
| • Impact power                  | 2.3 ft/lbs    |
| • Drilling capacity in concrete | 1.1"          |
| • Product weight                | 7.5 lbs       |

**PUREPOWER**  
BRUSHLESS

**TWIN-PACK®**  
18V + 18V = 36V  
TECHNOLOGY

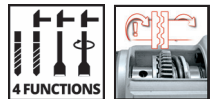

2.0 Ah	2.5 Ah	4.0 Ah	5.2 Ah	6.0 Ah	8.0 Ah
Up to 79 holes	Up to 105 holes	Up to 169 holes	Up to 222 holes	Up to 276 holes	Up to 368 holes

5/16" x 2" deep holes in concrete



## Screw Gun - Bare Tool

### 18V Cordless Drywall Screwdriver

Article No. **4259985**

**TE-DY 18 Li-Solo**

UPC 7-72995-01759-1

**EXPERT**

**POWER X-CHANGE**



#### Features

- Adjustable depth stop for precise depth setting
- Low-fatigue operation thanks to continuous operation setting
- Integrated pressure coupling for user-friendly screw driving
- Ergonomic softgrip surfaces
- Complete with LED lamp to illuminate the work area
- Quick and intuitive bit change thanks to the magnetic bit holder
- Practical belt clip for efficient and safe operation
- Comes in E-Box case
- Recommended battery for maximum results: 2.0 or 2.5 Ah battery
- Battery and charger sold separately

#### Technical Data

- No load speed 0 - 4,000 RPM
- Tool collet 1/4"
- Product weight 2.15 lbs



2.0 Ah	2.5 Ah	4.0 Ah	5.2 Ah	6.0 Ah	8.0 Ah
Up to 1100 screws	Up to 1350 screws	Up to 2200 screws	Up to 2800 screws	Up to 3300 screws	Up to 4400 screws

1" screws in drywall

## Mixer - Bare Tool

### 18V Cordless Mortar/Grout Mixer

Article No. **4258765**

**TE-MX 18 Li**

UPC 7-72995-01945-8

**EXPERT**

**POWER X-CHANGE**



#### Features

- Electronic speed control to suit material and application
- Ergonomically shaped handle for comfortable operation
- Durable and rugged aluminum housing
- Softstart function for comfortable and safe working
- Rugged M14 mixing paddle mount
- Comes with 4" diameter mortar mixing paddle
- Recommended battery for maximum results: 4.0 Ah battery
- Battery and charger sold separately

#### Technical Data

- Mixing paddle thread M14
- Mixing paddle diameter 4" (100 mm)
- No load speed 0 - 620 RPM
- Product weight 4.1 lbs



2.0 Ah	2.5 Ah	4.0 Ah	5.2 Ah	6.0 Ah	8.0 Ah
Up to 20 min	Up to 25 min	Up to 40 min	Up to 52 min	Up to 60 min	Up to 80 min

Max. operating time in idle mode

## Saws - Bare Tools

### 18V 6-1/2" Cordless Circular Saw

Article No. **4331215**

**TE-CS 18/165 Li-Solo**

UPC 7-72995-01764-5

**EXPERT**

**POWER X-CHANGE**



#### Features

- Easy adjustment without tools (cutting depth, tilt angle)
- Dust extractor adapter to keep the work place clean
- Ergonomic softgrip surfaces
- Complete with LED lamp to illuminate the work area
- Recommended battery for maximum results: 4.0 Ah battery
- Battery and charger sold separately

#### Technical Data

- No load speed 4,200 RPM
- Saw blade 6-1/2" x 5/8" x 1/16"
- Number of saw teeth 24 teeth
- Cutting depth at 90° 2-1/8"
- Cutting depth at 45° 1-3/8"
- Product weight 5.5 lbs

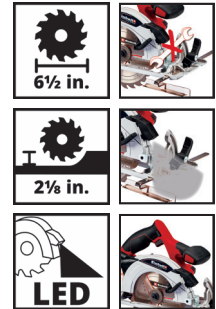

2.0 Ah	2.5 Ah	4.0 Ah	5.2 Ah	6.0 Ah	8.0 Ah
Up to 108 ft	Up to 131 ft	Up to 210 ft	Up to 270 ft	Up to 321 ft	Up to 419 ft

Rip cutting 3/4" OSB

## Saws - Bare Tools

### 18V 7-1/4" Cordless Circular Saw - Brushless

Article No. **4331211**

**TP-CS 18/190 Li BL-Solo**

UPC 7-72995-01763-8

**PROFESSIONAL**

**POWER X-CHANGE**



#### Features

- Brushless motor - more power and longer runtimes
- Easy adjustment without tools (cutting depth, tilt angle)
- Complete with LED lamp to illuminate the work area
- Ergonomic softgrip surfaces
- Dust extraction adapter to keep the workplace clean
- Parallel stop for precise cuts
- Recommended battery for maximum results: 4.0 Ah battery
- Battery and charger sold separately

#### Technical Data

- No load speed 3,800 RPM
- Saw blade 7-1/4" x 5/8" x 3/16"
- Number of saw teeth 24 teeth
- Cutting depth at 90° 1-3/4"
- Cutting depth at 45° 2-1/2"
- Product weight 7.1 lbs

**PUREPOWER**  
BRUSHLESS



2.0 Ah	2.5 Ah	4.0 Ah	5.2 Ah	6.0 Ah	8.0 Ah
Up to 78 ft	Up to 98 ft	Up to 160 ft	Up to 206 ft	Up to 239 ft	Up to 291 ft

Rip cutting 3/4" OSB



## Saws - Bare Tools

### 18V Cordless Reciprocating Saw

Article No. **4326307**

**TE-AP 18/22 Li-Solo**

UPC 7-72995-01761-4

**EXPERT**

**POWER X-CHANGE**



#### Features

- Tool-free blade changes for quick application
- Adjustable soleplate for optimum blade use
- Ergonomic softgrip surfaces
- Rubber supports to protect the housing
- Comes with 6"- 7 TPI wood saw blade
- Recommended battery for maximum results: 2.0 or 2.5 Ah battery
- Battery and charger sold separately

#### Technical Data

- No load speed 0 - 2,600 RPM
- Stroke length 7/8"
- Cutting depth in wood 4"
- Cutting depth in metal 1/4"
- Product weight 3.52 lbs

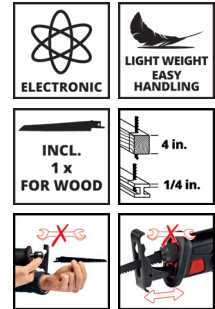

2.0 Ah	2.5 Ah	4.0 Ah	5.2 Ah	6.0 Ah	8.0 Ah
Up to 180 cuts	Up to 240 cuts	Up to 370 cuts	Up to 570 cuts	Up to 580 cuts	Up to 740 cuts

Max. cuts in 1-3/8" round timber

## Saws - Bare Tools

### 18V Cordless Reciprocating Saw - Brushless

Article No. **4326311**

**TP-AP 18/28 Li-BL-Solo**

UPC 7-72995-01762-1

**PROFESSIONAL**

**POWER X-CHANGE**



#### Features

- Brushless motor - more power and longer runtimes
- Rotatable main handle for maximum flexibility
- Anti-vibration function ensures low vibration during operation
- Adjustable soleplate for optimum blade use
- Tool-free blade changes for quick application
- Ergonomic softgrip surfaces
- Comes with 6"- 7 TPI wood saw blade
- Recommended battery for maximum results: 2.0 or 2.5 Ah battery
- Battery and charger sold separately

#### Technical Data

- No load speed 0 - 2,500 RPM
- Stroke length 1-1/8"
- Cutting depth in wood 8"
- Cutting depth in plastic 13/16"
- Cutting depth in metal 1/2"
- Product weight 4.53 lbs

**PUREPOWER**  
BRUSHLESS

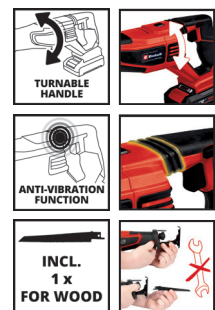

2.0 Ah	2.5 Ah	4.0 Ah	5.2 Ah	6.0 Ah	8.0 Ah
Up to 226 cuts	Up to 332 cuts	Up to 556 cuts	Up to 723 cuts	Up to 834 cuts	Up to 1112 cuts

Max. cuts in 1-3/8" round timber

## Saws - Bare Tools

### 18V Variable Speed Cordless Jigsaw

Article No. **4321235**

**TC-JS 18 Li**

UPC 7-72995-01946-5

**CLASSIC**

**POWER X-CHANGE**



#### Features

- Very smooth operation for exact cutting
- Selectable orbital action for fast cutting
- Tool-free universal blade holder
- Includes dust blow-off function for optimum visibility
- Integrated plastic soleplate for sensitive workpieces
- Recommended for maximum results: 2.0 or 2.5 Ah battery
- Battery and charger sold separately

#### Technical Data

- |                            |               |
|----------------------------|---------------|
| • Strokes per minute       | 0 - 2,700 SPM |
| • Stroke                   | 1"            |
| • Cutting depth in wood    | 3-1/4"        |
| • Cutting depth in plastic | 1/2"          |
| • Cutting depth in metal   | 13/32"        |
| • Max. bevel capacity      | 45°           |
| • Product weight           | 4.4 lbs       |

#### Standard Accessory

- KWB jigsaw blade

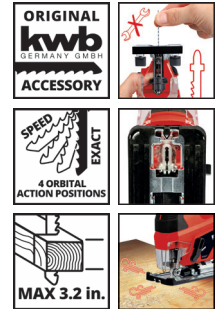

2.0 Ah	2.5 Ah	4.0 Ah	5.2 Ah	6.0 Ah	8.0 Ah
Up to 31 ft	Up to 36 ft	Up to 65 ft	Up to 98 ft	Up to 104 ft	Up to 131 ft

Rip cutting 3/4" OSB

## Saws - Bare Tools

### 18V Variable Speed Cordless Jigsaw

Article No. **4321233**

**TE-JS 18/80 Li-Solo**

UPC 7-72995-01768-3

**EXPERT**

**POWER X-CHANGE**



#### Features

- Very smooth operation for exact cutting
- Selectable pendulum action for fast cutting
- Tool-free universal blade holder
- Includes dust blow-off function for optimum visibility
- Complete with LED lamp to illuminate the work area
- Integrated plastic sliding element for sensitive workpieces
- Ergonomic softgrip surfaces
- Complete with chip guard for cuts without splintering
- Recommended battery for maximum results: 2.0 or 2.5 Ah battery
- Battery and charger sold separately

#### Technical Data

- |                            |               |
|----------------------------|---------------|
| • Strokes per minute       | 0 - 2,400 SPM |
| • Stroke                   | 1"            |
| • Cutting depth in wood    | 3-1/4"        |
| • Cutting depth in plastic | 1/2"          |
| • Cutting depth in metal   | 5/32"         |
| • Max. bevel capacity      | 47°           |
| • Product weight           | 3.85 lbs      |

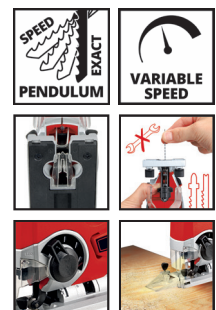

2.0 Ah	2.5 Ah	4.0 Ah	5.2 Ah	6.0 Ah	8.0 Ah
Up to 31 ft	Up to 36 ft	Up to 65 ft	Up to 98 ft	Up to 104 ft	Up to 131 ft

Rip cutting 3/4" OSB



## Saws - Bare Tools

### 18V Variable Speed Cordless Jigsaw - Brushless

Article No. **4321263**

TP-JS 18/135 Li BL

UPC 7-72995-01948-9

**PROFESSIONAL**

**POWER X-CHANGE**



#### Features

- Brushless motor - more power and longer runtimes
- Tool-free universal blade holder
- Includes dust blow-off function for optimum visibility
- Complete with LED lamp to illuminate the work area
- Integrated plastic sliding element for sensitive workpieces
- Ergonomic softgrip surfaces
- Complete with chip guard for cuts without splintering
- Recommended battery for maximum results: 2.0 or 2.5 Ah battery
- Battery and charger sold separately

#### Technical Data

- |                                    |               |
|------------------------------------|---------------|
| • Speeds                           | 7 settings    |
| • Strokes per minute               | 0 - 3,500 SPM |
| • Stroke                           | 1-1/32"       |
| • Max. cutting capacity in wood    | 5-1/4"        |
| • Max. cutting capacity in plastic | 13/16"        |
| • Max. cutting capacity in metal   | 13/32"        |
| • Orbital settings                 | 4             |
| • Product weight                   | 4.85 lbs      |

**PUREPOWER**  
BRUSHLESS

**SOFT GRIP**



**BEST PERFORMANCE WITH ≥ 2.5 Ah**



**LED**



2.0 Ah	2.5 Ah	4.0 Ah	5.2 Ah	6.0 Ah	8.0 Ah
Up to 14 min	Up to 18 min	Up to 29 min	Up to 37 min	Up to 43 min	Up to 57 min

Max. operating time in idle mode

## Saws - Bare Tools

### 18V Variable Speed Cordless Jigsaw w/ Barrel Grip - Brushless

Article No. **4321267**

TP-JST 18/135 Li BL

UPC 7-72995-01949-6

**PROFESSIONAL**

**POWER X-CHANGE**



#### Features

- Brushless motor - more power and longer runtimes
- Barrel grip handle for easy tool guidance overhead
- Tool-free universal blade holder
- Includes dust blow-off function for optimum visibility
- Complete with LED lamp to illuminate the work area
- Integrated plastic sliding element for sensitive workpieces
- Ergonomic softgrip surfaces
- Complete with chip guard for cuts without splintering
- Recommended battery for maximum results: 2.0 or 2.5 Ah battery
- Battery and charger sold separately

#### Technical Data

- |                                 |               |
|---------------------------------|---------------|
| • Strokes per minute            | 0 - 3,500 SPM |
| • Stroke                        | 1-1/32"       |
| • Max. cutting depth in wood    | 5-1/4"        |
| • Max. cutting depth in plastic | 13/16"        |
| • Max. cutting depth in metal   | 13/32"        |
| • Orbital settings              | 4             |
| • Product weight                | 4.3 lbs       |

**PUREPOWER**  
BRUSHLESS

**SOFT GRIP**



**BEST PERFORMANCE WITH ≥ 2.5 Ah**



**LED**



2.0 Ah	2.5 Ah	4.0 Ah	5.2 Ah	6.0 Ah	8.0 Ah
Up to 14 min	Up to 18 min	Up to 29 min	Up to 37 min	Up to 43 min	Up to 57 min

Max. operating time in idle mode

## Saws - Bare Tools

### 18V Cordless Oscillating Multi-Tool

Article No. **4465165**

**VARRITO-Solo**

UPC 7-72995-01767-6

**EXPERT**

**POWER X-CHANGE**



#### Features

- Quick release for tool-free change of equipment
- Comfortable accessory change thanks to magnetic tool fixation
- Speed electronics for material and application
- Oscillation decoupled battery uptake for reduction of vibration
- Ergonomic softgrip surfaces
- 12-pin-tool universal blade adaptor for flexible positioning of equipment
- Recommended battery for maximum results: 2.0 or 2.5 Ah battery
- Battery and charger sold separately

#### Technical Data

- Angle of oscillation 3.2° (total)
- Oscillating speed 22,000 - 40,000 OPM
- No load speed 11,000 - 20,000 RPM
- Sandpaper size 3.5" x 3.5" x 3.5"
- Product weight 2.25 lbs

#### Standard Accessories

- Triangular grinding/sanding plate
- 9 x grinding/sanding paper (3 x 60, 80, 120 Grit)
- Scraper
- Plunge-cut saw blade for wood and plastic (HCS)
- BIM plunge-cut saw blade for metal
- Segment saw blade for wood, plastic and soft metal (HSS)
- Diamond segment saw blade for tile joint



2.0 Ah	2.5 Ah	4.0 Ah	5.2 Ah	6.0 Ah	8.0 Ah
Up to 720 cuts	Up to 900 cuts	Up to 1440 cuts	Up to 1880 cuts	Up to 2160 cuts	Up to 2880 cuts

Cutting through round plastic Ø 3/8"

## Saws - Bare Tools

### 18V Cordless Oscillating Multi-Tool - Brushless

Article No. **4465191**

**TP-MG 18 Li BL**

UPC 7-72995-01926-7

**PROFESSIONAL**

**POWER X-CHANGE**



#### Features

- Brushless motor – more power and longer runtimes
- Innovative anti-vibration head for vibration reduction
- 3 functions: grinding, sawing and scraping
- Quick-release tool-free accessory change
- Electronic speed control to suit material and application
- 12-pin tool holder for flexible positioning of accessories
- Convenient accessory change thanks to magnetic tool holder
- LED light for optimal illumination of the work area
- Recommended battery for maximum results: 2.0 or 2.5 Ah battery
- Battery and charger sold separately

#### Technical Data

- Angle of oscillation L/R: 1.6° (3.2° total)
- Oscillating speed 22,000 - 40,000 OPM
- No load speed 11,000 - 20,000 RPM
- Sandpaper size 3.5" x 3.5" x 3.5"
- Product weight 2.4 lbs

#### Standard Accessories

- Triangular grinding/sanding plate
- 9 x grinding/sanding paper (3 x 60, 80, 120 Grit)
- Scraper
- Plunge-cut saw blade for wood and plastic (HCS)
- BIM plunge-cut saw blade for metal
- Segment saw blade for wood, plastic and soft metal (HSS)
- Diamond segment saw blade for tile joint

**PUREPOWER**  
BRUSHLESS



2.0 Ah	2.5 Ah	4.0 Ah	5.2 Ah	6.0 Ah	8.0 Ah
Up to 34 min	Up to 43 min	Up to 68 min	Up to 89 min	Up to 102 min	Up to 136 min

Max. operating time in idle mode



## Saws - Bare Tools

### 36V 8-1/4" Cordless Table Saw

Article No. **4340451**

**TE-TS 36/210 Li-Solo**

UPC 7-72995-01784-3

**EXPERT**

**POWER X-CHANGE**



#### Features

- TWIN-PACK technology: 2 x 18V Power X-Change batteries required
- Portable, mobile, with no annoying power cord
- Sturdy aluminum table
- Small and compact, ideal for limited space or mobile use
- The softstart function protects both the motor and the gear unit
- Ultra-sturdy rip fence for exact longitudinal cuts
- High-grade carbide-tipped saw blade, developed for cordless saws
- Infinitely height adjustable saw blade for extra safety
- Extractor connection on housing and saw blade guard for less mess
- Holders for stowing away all the attachments on the equipment
- Recommended batteries for maximum results: 2 x 4.0 batteries
- Batteries and charger sold separately

#### Technical Data

- |                                     |                   |
|-------------------------------------|-------------------|
| • No load speed                     | 3,800 RPM         |
| • Saw blade                         | 8-1/4"            |
| • Number of saw teeth               | 40 teeth          |
| • Bevel range                       | 90° - 45°         |
| • Angle stop                        | -60° - +60°       |
| • Max. cutting height 90/45°        | 2-3/4" / 1-3/4"   |
| • Max. cutting width right          | 24-3/4"           |
| • Main table dimensions             | 18-7/8" x 18-3/8" |
| • Max. support surface              | 18-7/8" x 21-1/8" |
| • Diameter of extraction connection | 1-3/8"            |
| • Product weight                    | 28.8 lbs          |

**TWIN-PACK®**  
18V + 18V = 36V  
TECHNOLOGY

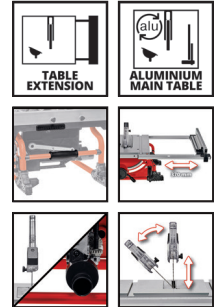

<b>2.0 Ah</b>	<b>2.5 Ah</b>	<b>4.0 Ah</b>	<b>5.2 Ah</b>	<b>6.0 Ah</b>	<b>8.0 Ah</b>
Up to <b>196</b> ft	Up to <b>232</b> ft	Up to <b>400</b> ft	Up to <b>524</b> ft	Up to <b>603</b> ft	Up to <b>800</b> ft

Max cutting distance in 3/4" OSB

## Tile Saw - Bare Tool

### 18V 4-1/2" Cordless Wet Tile Saw

Article No. **4301191**

**TE-TC 18/115 Li**

UPC 7-72995-01921-2

**EXPERT**

**POWER X-CHANGE**



#### Features

- Flexible usage everywhere due to battery driven motor and low weight
- Tilting table with angle scale (0 - 45°)
- Integrated water tank for tile saw blade cooling and dust reduction
- Non-slip and vibration rubber feet
- Rip fence with angle scale for exact cuts
- Adjustable (-45° - 45°) angle stop for miter cuts
- Carry handle for easy transport
- Blade guard provides safety for the end user
- Complete with diamond tile saw blade and a tool for changing it
- Recommended for maximum results: 2.5 Ah or 4.0 Ah battery
- Battery and charger sold separately

#### Technical Data

- |                           |                   |
|---------------------------|-------------------|
| • No load speed           | 3,800 RPM         |
| • Cutting capacity at 45° | 5/8"              |
| • Cutting capacity at 90° | 15/16"            |
| • Blade                   | Ø 4-1/2" - Ø 7/8" |
| • Product weight          | 7.9 lbs           |



<b>2.0 Ah</b>	<b>2.5 Ah</b>	<b>4.0 Ah</b>	<b>5.2 Ah</b>	<b>6.0 Ah</b>	<b>8.0 Ah</b>
Up to <b>295</b> inches	Up to <b>371</b> inches	Up to <b>590</b> inches	Up to <b>767</b> inches	Up to <b>885</b> inches	Up to <b>1180</b> inches

Max. length of cutting on 9/16" thick ceramic tile

## Sanders - Bare Tools

### 18V Cordless Palm Detail Sander

Article No. **4460721**

**TE-OS 18/150 Li-Solo**

UPC 7-72995-01770-6

**EXPERT**

**POWER X-CHANGE**



#### Features

- Ergonomic softgrip surfaces
- Small, compact and easy to handle
- Ideal for sanding corners and small surfaces
- "Extreme Fix" fastening for quick change of sanding paper
- High removal rate with "Extreme Fix" due to reduced slippage
- Solid, rugged aluminum fan impeller for smooth running
- Active dust extraction keeps the work area clean
- Recommended battery for maximum results: 2.0 or 2.5 Ah battery
- Battery and charger sold separately

#### Technical Data

- No load speed 12,000 RPM
- Oscillating speed 24,000 OPM
- Oscillating circuit 1/16"
- Sanding area 6" x 6" x 4"
- Sanding paper size (velcro) 6" x 6" x 4"
- Product weight 1.76 lbs

#### Standard Accessories

- Vacuum cleaner adapter
- 6 sheets of sanding paper (3 x 120 Grit | 3 x 240 Grit)

**SOFT GRIP**



**BEST PERFORMANCE WITH ≥ 2.5 Ah**

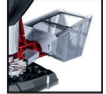

**LIGHT WEIGHT EASY HANDLING**



#### Optional Accessory

Article No. **4460736**

15 pc. Sandpaper Kit  
(5 x 60, 5 x 120, 5 x 180 Grit)

UPC 7-72995-01799-7



Max. operating time in idle mode

## Sanders - Bare Tools

### 18V 5" Cordless Random Orbit Sander

Article No. **4462012**

**TE-RS 18 Li-Solo**

UPC 7-72995-01771-3

**EXPERT**

**POWER X-CHANGE**



#### Features

- Electronic speed control
- Finest finish & high sanding performance due to eccentric concept
- Ergonomic softgrip surfaces
- Hook and loop fastening for holding the abrasive paper securely
- Both integrated and connection for external dust extraction
- Comes with an abrasive sanding paper (80 Grit)
- Recommended battery for maximum results: 2.0 or 2.5 Ah battery
- Battery and charger sold separately

#### Technical Data

- No load speed 7,000 - 11,000 RPM
- Oscillating speed 14,000 - 22,000 OPM
- Oscillating circuit 5/64"
- Backing pad diameter 5"
- Sanding paper diameter 5"
- Product weight 2.53 lbs

**Ø 5 in.**



**14000 - 22000 rpm**



**Ø 5/64 in. (2 mm)**



#### Optional Accessory

Article No. **4460737**

25 pc. Sandpaper Kit  
(9 x 60, 8 x 120, 8 x 180 Grit)

UPC 7-72995-01801-7



Max. operating time in idle mode



## Sanders - Bare Tools

### 18V 5" Cordless Random Orbit Sander - Brushless

Article No. **4462021**

TP-RS 18/32 Li BL

UPC 7-72995-01916-8

**EXPERT**

**POWER X-CHANGE**



#### Features

- Brushless motor – more power and longer runtimes
- Electronic speed control to suit material and application
- Removable additional handle
- Flat design for more control while sanding
- Safe and comfortable working thanks to softgrip
- Dust extraction with dust collection box and pleated filter
- Comes with 3 x sanding discs (60/80/120 Grit) and dust collection box
- Recommended battery for maximum results 2.0 or 2.5 Ah battery
- Battery and charger sold separately

#### Technical Data

- No load speed 3,000 - 12,000 RPM
- Oscillating speed 6,000 - 24,000 OPM
- Oscillating circuit 1/8"
- Sanding disc size 5"
- Product weight 2.4 lbs



2.0 Ah	2.5 Ah	4.0 Ah	5.2 Ah	6.0 Ah	8.0 Ah
Up to 29 min	Up to 36 min	Up to 58 min	Up to 75 min	Up to 87 min	Up to 115 min

Max. operating time in idle mode

#### Optional Accessory

Article No. **4460737**

25 pc. Sandpaper Kit  
(9 x 60, 8 x 120, 8 x 180 Grit)

UPC 7-72995-01801-7



## Sanders - Bare Tools

### 18V Cordless File Belt Sander

Article No. **4461010**

TE-BF 18 Li

UPC 7-72995-01950-2

**EXPERT**

**POWER X-CHANGE**



#### Features

- 90° swiveling sanding arm - adjustment to any working position
- Two exchangeable sanding arms for various tasks
- Narrow sanding arm for narrow areas and delicate work
- Wide sanding arm for larger, flat surfaces
- Variable speed control of the sanding belt
- Tool-free, simple sanding belt change
- Tool-free sanding belt adjustment directly on the sanding arm
- Robust sanding arm housing made of solid metal
- Continuous running lock for time-intensive work
- Handle and additional handle with softgrip
- Ergonomic, slim and lightweight design
- Comes with dust chute adapter for wet-dry vacuums
- 12 pieces of sanding belts (2 belt widths 3/8" & 1/2" -60/80/120 Grit)
- Recommended for maximum results: 2.5 Ah battery
- Battery and charger sold separately

#### Technical Data

- Variable speed range 250 - 1,700 RPM
- Sanding arm angle adjustment 90°
- Quantity sanding arms 2 pcs
- Sanding belt length 18"
- Product weight 2.5 lbs



2.0 Ah	2.5 Ah	4.0 Ah	5.2 Ah	6.0 Ah	8.0 Ah
Up to 15 min	Up to 18 min	Up to 30 min	Up to 39 min	Up to 45 min	Up to 60 min

Max. operating time in idle mode

#### Optional Accessories

Article No. **4419818**

35 pc. 3/8" x 18" Sanding Belt Kit

UPC 7-72995-02044-7



Article No. **4419819**

35 pc. 1/2" x 18" Sanding Belt Kit

UPC 7-72995-02043-0



## Sanders - Bare Tools

# 18V Cordless 3" x 18" Belt Sander - Brushless

Article No. **4466271**

TP-BS 18/457 Li BL

UPC 7-72995-01922-9

**PROFESSIONAL**

**POWER X-CHANGE**



## Features

- Brushless motor – more power and longer runtimes
- Electronic speed control for material & usage-oriented work
- Tool-free sanding belt change thanks to locking lever
- Precise belt tracking adjustment
- Handle and additional handle with softgrip for optimal handling
- Integrated storage surface for stationary use
- Continuous use lock for comfortable working
- Integrated dust extraction and extraction adapter
- Dust collection box for dust-free workplace
- Comes with 3 sanding belts (80 Grit)
- Recommended for maximum results: 2.5 Ah battery
- Battery and charger sold separately

## Technical Data

- Belt speed 394 - 820 ft/min
- Sanding belt 3" x 18"
- Sanding surface 3" x 5"
- Product weight 5.5 lbs



2.0 Ah	2.5 Ah	4.0 Ah	5.2 Ah	6.0 Ah	8.0 Ah
Up to 15 min	Up to 18 min	Up to 30 min	Up to 38 min	Up to 44 min	Up to 59 min

Max. operating time in idle mode

## Drywall Sander - Bare Tool

# 18V 9" Cordless Drywall Sander

Article No. **4259992**

TP-DW 18/225 Li

UPC 7-72995-01923-6

**PROFESSIONAL**

**POWER X-CHANGE**



## Features

- Electronic speed control for adjusting to material & application
- Switch with lock button for low-fatigue operation
- Integrated dust extraction system for clean work area
- Sanding disk with spring bearing for optimum contact to the wall
- Sanding disk with micro hook-and-loop fastening
- Swivel brush ring for keeping the workplace clean
- Folding handle for easy transport and storage
- Softgrip surfaces enable operation without fatigue
- Supplied in a practical transport E-case
- Recommended for maximum results: 2.5 or 4.0 Ah battery
- Battery and charger sold separately

## Technical Data

- Variable speed range 600 - 1,200 RPM
- Wheel diameter 9"
- Item length 65"
- Hose length 78"
- Product weight 7.9 lbs

## Standard Accessories

- Extension hose with an integrated supporting foot
- Dust bag with a quick-release fastener and harness
- 6x sanding discs and 1x abrasive mesh
- Adapter for connecting a suitable vacuum cleaner



2.0 Ah	2.5 Ah	4.0 Ah	5.2 Ah	6.0 Ah	8.0 Ah
Up to 27 min	Up to 33 min	Up to 53 min	Up to 69 min	Up to 80 min	Up to 110 min

Max. operating time in idle mode

## Angle Grinders - Bare Tools

### 18V 4-1/2" Cordless Angle Grinder

Article No. **4431122**

**TE-AG 18/115 Li-Solo**

UPC 7-72995-01766-9

**EXPERT**

**POWER X-CHANGE**



#### Features

- Softstart function and restart safeguard to make it safer to use
- Overload cut-out for a long service life
- Very smooth operation thanks to separation of motor and gearing
- Disc guard with quick adjust facility
- Robust aluminum gear housing
- Additional handle can be fitted flexibly in 3 positions
- Cutting disc not included
- Recommended battery for maximum results: 2.5 Ah battery
- Battery and charger sold separately

#### Technical Data

- Grinding wheel diameter 4-1/2"
- No load speed 8,500 RPM
- Max. cutting depth 1.1"
- Spindle thread 5/8" - 11 UNC
- Arbor 7/8"
- Product weight 2.66 lbs

2.0 Ah	2.5 Ah	4.0 Ah	5.2 Ah	6.0 Ah	8.0 Ah
Up to 20 cuts	Up to 25 cuts	Up to 40 cuts	Up to 60 cuts	Up to 70 cuts	Up to 80 cuts

Cutting through round steel Ø 7/16"

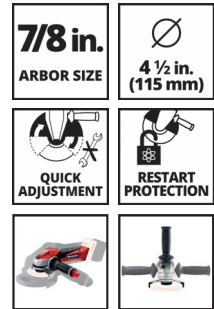

## Angle Grinders - Bare Tools

### 18V 4-1/2" Cordless Angle Grinder - Brushless

Article No. **4431147**

**AXXIO 18/115 Q**

UPC 7-72995-01939-7

**PROFESSIONAL**

**POWER X-CHANGE**



#### Features

- Brushless motor - more power and longer runtimes
- Quick fix nut for an easy and tool-free grinding wheel change
- Softstart function and restart safeguard to make it safer for use
- Overload cut-out for a long service life
- Grinding wheel guard with quick adjust lever
- Robust aluminium gearing housing
- Additional handle can be fitted in 2 positions
- Grinding wheel not included
- Recommended for maximum results: 2.5 Ah battery
- Battery and charger sold separately

#### Technical Data

- Grinding wheel diameter 4-1/2"
- No load speed 8,500 RPM
- Max. cutting depth 1.1"
- Spindle thread 5/8" - 11 UNC
- Arbor 7/8"
- Product weight 3.4 lbs

2.0 Ah	2.5 Ah	4.0 Ah	5.2 Ah	6.0 Ah	8.0 Ah
Up to 29 cuts	Up to 37 cuts	Up to 63 cuts	Up to 92 cuts	Up to 94 cuts	Up to 126 cuts

Cutting through round steel Ø 1/2"

**PUREPOWER**  
BRUSHLESS



## Angle Grinders - Bare Tools

### 18V 5" Cordless Angle Grinder - Brushless

Article No. **4431143**

**AXXIO 18/125-Solo**

UPC 7-72995-01765-2

**PROFESSIONAL**

**POWER X-CHANGE**



#### Features

- Brushless motor - more power and longer runtimes
- Softstart function and restart safeguard to make it safer to use
- Overload cut-out for a long service life
- Very smooth operation thanks to separation of motor and gearing
- Disc guard with quick adjust lever for flexible working
- Robust aluminum gearing housing
- Dust protection guard protects the item from invading dust
- Additional handle can be fitted in 2 positions
- Cutting disc not included
- Recommended battery for maximum results: 2.5 or 4.0 Ah battery
- Battery and charger sold separately

#### Technical Data

- Grinding wheel diameter 5"
- No load speed 8,500 RPM
- Max. cutting depth 1.29"
- Spindle thread 5/8" - 11 UNC
- Arbor 7/8"
- Product weight 3.16 lbs

2.0 Ah	2.5 Ah	4.0 Ah	5.2 Ah	6.0 Ah	8.0 Ah
Up to 33 cuts	Up to 37 cuts	Up to 61 cuts	Up to 85 cuts	Up to 92 cuts	Up to 122 cuts

Cutting through round steel Ø 7/16"

**PUREPOWER**  
BRUSHLESS





## Polishers - Bare Tools

### 18V 10" Cordless Car Polisher

Article No. **2093303**

CE-CB 18/254 Li-Solo

UPC 7-72995-01773-7

**EXPERT**

**POWER X-CHANGE**



#### Features

- 2-in-1 product: Polishing and buffing with a single tool
- Ergonomic handle for an optimum hold and controlled operation
- Ergonomic softgrip surfaces
- Hook-and-loop fastener for changing the attachments quickly
- Recommended battery for maximum results: 2.0 or 2.5 Ah battery
- Battery and charger sold separately

#### Technical Data

- No load speed 2,500 RPM
- Diameter 10"
- Product weight 4.24 lbs

#### Standard Accessories

- 1 textile bonnet
- 1 synthetic polishing bonnet



2.0 Ah	2.5 Ah	4.0 Ah	5.2 Ah	6.0 Ah	8.0 Ah
Up to 81 min	Up to 93 min	Up to 127 min	Up to 200 min	Up to 222 min	Up to 254 min

Max. operating time in idle mode

#### Optional Accessory

Article No. **2093096** 2 pc. Polishing Bonnets Kit  
(1 textile bonnet, 1 synthetic bonnet)

UPC 7-72995-01803-1



## Polishers - Bare Tools

### 18V 7" Cordless Polisher-Orbital Sander - Brushless

Article No. **2093325**

CE-CP 18/180 Li E

UPC 7-72995-01774-4

**EXPERT**

**POWER X-CHANGE**



#### Features

- Brushless motor - more power and longer runtimes
- 2-in-1 product: polishing and grinding/sanding with a single tool
- Electronic speed control via LCD display
- Ergonomic handle for an optimum hold and controlled operation
- Slimline design with ergonomic softgrip surfaces
- Hook-and-loop fastener for changing the attachments quickly
- Spindle locking system for easy attachment of the polishing disc
- Large polishing disc with 7" diameter for speedy progress
- Recommended battery for maximum results: 2.5 Ah battery
- Battery and charger sold separately

#### Technical Data

- Diameter of sanding plate 7"
- No load speed 500 - 3,000 RPM
- Spindle thread 5/8" - 11 UNC
- Product weight 3.5 lbs

#### Standard Accessories

- 1 foam attachment
- 1 synthetic polishing bonnet
- 3 sanding papers (1 x 60, 80, 120 Grit)

**PUREPOWER**  
BRUSHLESS



2.0 Ah	2.5 Ah	4.0 Ah	5.2 Ah	6.0 Ah	8.0 Ah
Up to 20 min	Up to 25 min	Up to 43 min	Up to 54 min	Up to 65 min	Up to 86 min

Max. operating time in idle mode

#### Optional Accessory

Article No. **2093239** 9 pc. 7" Polishing/Sanding Kit  
Comes with:

- 1 foam attachment
- 2 synthetic polishing bonnets
- 6 sanding papers (2 x 60, 80, 120 Grit)

UPC 7-72995-01804-8



## Specialty Tools - Bare Tools

### 18V 18-Gauge Cordless Brad Nailer

Article No. **4257796**

**FIXETTO 18/50 N**

UPC 7-72995-01924-3

**PROFESSIONAL**

**POWER X-CHANGE**



#### Features

- PressAir technology: Maintenance-free
- Robust gearbox allows up to 60 impacts per minute
- Switchable between single and bump-firing modes
- Tool-free depth adjustment for precise work
- Robust design with ergonomic handle
- Large magazine with fill level indicator for up to 100 nails
- Open the magazine with a push of a button
- Tool-free removal of jammed brad nails
- Safety against unintentional release of the nailer
- Two LEDs illuminate the working area
- Ergonomic softgrip surface for good grip & comfortable working
- No scratching of the workpiece thanks to rubberized sides
- Practical belt clip for additional user comfort
- Suitable for 5/8" - 2" long and 0.047" thick brad nails
- 500 brad nails included
- Recommended for maximum results: 2.5 Ah battery
- Battery and charger sold separately

#### Technical Data

- Nail length 5/8" - 2"
- Nail diameter 0.047"
- Max. number of shots 60 per min.
- Magazine capacity 100 brad nails
- Product weight 6.1 lbs



	2.0 Ah	2.5 Ah	4.0 Ah	5.2 Ah	6.0 Ah	8.0 Ah
<sup>1</sup> Up to	Up to	Up to	Up to	Up to	Up to	Up to
<b>840 nails</b>	<b>1050 nails</b>	<b>1679 nails</b>	<b>2183 nails</b>	<b>2519 nails</b>	<b>3358 nails</b>	
<sup>2</sup> Up to	Up to	Up to	Up to	Up to	Up to	Up to
<b>685 nails</b>	<b>857 nails</b>	<b>1370 nails</b>	<b>1781 nails</b>	<b>2055 nails</b>	<b>2740 nails</b>	

1: Max. 1.25" nails in softwood --- 2: Max. 2" nails in softwood

## Specialty Tools - Bare Tools

### 18V Cordless Drain Auger

Article No. **4514165**

**TE-DA 18/760 Li**

UPC 7-72995-01947-2

**EXPERT**

**POWER X-CHANGE**



#### Features

- Easy retraction/extension of drain auger cable
- Right/left rotation for release when the cable is blocked
- Galvanized cable prevents rust
- Convenient cleaning of the drum thanks to the outlet opening
- Locking mechanism for freeing up stubborn dirt
- Suitable for pipes 5/8" - 2-1/4" due to its 1/4" cable
- LED light for illuminating the working area
- Recommended battery for maximum results: 2.0 or 2.5 Ah battery
- Battery and charger sold separately

#### Technical Data

- No load speed 0 - 560 RPM
- Cable length 22 feet
- Cable diameter 1/4"
- Min. pipe diameter 5/8"
- Max. pipe diameter 2-1/4"
- Product weight 8.13 lbs



	2.0 Ah	2.5 Ah	4.0 Ah	5.2 Ah	6.0 Ah	8.0 Ah
Up to	Up to	Up to	Up to	Up to	Up to	Up to
<b>56 min</b>	<b>68 min</b>	<b>112 min</b>	<b>143 min</b>	<b>188 min</b>	<b>224 min</b>	

Max. operating time in idle mode

## Specialty Tools - Bare Tools

# 18V Cordless Compact Router - Brushless

Article No. **4350415**

TP-ET 18 Li BL

UPC 7-72995-01911-3

**PROFESSIONAL**

**POWER X-CHANGE**



## Features

- Brushless motor - more power and longer runtimes
- Electronic speed control with powerful motor
- Adjustable routing depth adjustment
- Spindle lock for easy tool change
- LED for optimum illumination of the work area
- Plastic base plate insert protects the work surface
- Ergonomic handle with softgrip
- High quality aluminum enables precise milling
- Comes with edge guide, compass point, trimmer roller guide, collet, template guide and dust chute
- Recommended battery for maximum results: 2.0 or 2.5 Ah battery
- Battery and charger sold separately

## Technical Data

- |                            |                     |
|----------------------------|---------------------|
| • Stroke                   | 1.58"               |
| • No load speed            | 10,000 - 30,000 RPM |
| • Collet                   | 1/4"                |
| • Max. diameter router bit | 1.18"               |
| • Product weight           | 2.87 lbs            |

**PUREPOWER**  
BRUSHLESS

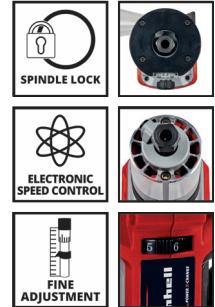

2.0 Ah	2.5 Ah	4.0 Ah	5.2 Ah	6.0 Ah	8.0 Ah
Up to 95 ft	Up to 121 ft	Up to 190 ft	Up to 253 ft	Up to 289 ft	Up to 387 ft

1/8" deep milled grooves in softwood w/ 1/4" bit

## Specialty Tools - Bare Tools

# 18V Cordless Compact Router w/ Fixed & Plunge Base - Brushless

Article No. **4350413**

TP-RO 18 Set Li BL

UPC 7-72995-01910-6

**PROFESSIONAL**

**POWER X-CHANGE**



## Features

- Brushless motor - more power and longer runtimes
- Very smooth operation for exact cutting
- Selectable pendulum action for fast cutting
- Tool-free universal blade holder
- Includes dust blow-off function for optimum visibility
- Complete with LED lamp to illuminate the work area
- Integrated plastic sliding element for sensitive workpieces
- Ergonomic softgrip surfaces
- Complete with chip guard for cuts without splintering
- Recommended battery for maximum results: 2.0 or 2.5 Ah battery
- Battery and charger sold separately

## Technical Data

- |                            |   |
|----------------------------|---|
| • Stroke                   | 1.38" / 1.58"                                 |
| • No load speed            | 10,000 - 30,000 RPM                           |
| • Collet                   | 1/4"  |
| • Max. diameter router bit | 1.18"   |
| • Product weights          | 2.8 lbs (fixed base)<br>5.3 lbs (plunge base) |

**PUREPOWER**  
BRUSHLESS



2.0 Ah	2.5 Ah	4.0 Ah	5.2 Ah	6.0 Ah	8.0 Ah
Up to 95 ft	Up to 121 ft	Up to 190 ft	Up to 253 ft	Up to 289 ft	Up to 387 ft

1/8" deep milled grooves in softwood w/ 1/4" bit



## Specialty Tools - Bare Tools

### 18V 3-1/4" Cordless Portable Planer

Article No. **4345401**

**TE-PL 18/82 Li-Solo**

UPC 7-72995-01783-6

**EXPERT**

**POWER X-CHANGE**



#### Features

- Powerful hand-held planer for jobs with a chip depth of up to 1/16"
- Large knife shaft for optimum planing results
- Automatic park rest protecting the planing knife and workpiece
- Solid aluminum soleplates for flat results
- Soleplate with 1 V-shaped groove for easy chamfering of edges
- Ergonomic softgrip surfaces
- Recommended battery for maximum results: 2.0 or 2.5 Ah battery
- Battery and charger sold separately

#### Technical Data

- |                  |               |
|------------------|---------------|
| • No load speed  | 15,000 RPM    |
| • Planing width  | 3-1/4"        |
| • Planing depth  | 1/64" - 5/64" |
| • Rabbet depth   | 5/16"         |
| • Product weight | 5.34 lbs      |

#### Standard Accessories

- Parallel guide for straight and precise planning work
- Rabbet depth stop for easy production of heels
- 2 x TCT-Planing blades (reversible blades) for high surface quality

**SOFT GRIP**



**BEST PERFORMANCE WITH ≥ 2.5 Ah**



**LIGHT WEIGHT EASY HANDLING**



2.0 Ah	2.5 Ah	4.0 Ah	5.2 Ah	6.0 Ah	8.0 Ah
Up to 82 ft	Up to 92 ft	Up to 157 ft	Up to 190 ft	Up to 255 ft	Up to 314 ft

Planing in spruce wood (depth: 1/32" - width: 2")

## Specialty Tools - Bare Tools

### 18V Cordless Biscuit Joiner

Article No. **4350631**

**TE-BJ 18 Li**

UPC 7-72995-01907-6

**EXPERT**

**POWER X-CHANGE**



#### Features

- Adjustable angle setting up to 90°
- Adjustable height setting
- 6-step quick adjustment of cutting depth
- Suitable for standard biscuit size (#0, 10, 20, Supplex & Dimplex)
- Solid aluminium design enables precise cutting of slots
- Spindle lock for easy blade change
- Face spanner for blade change included
- Complete with dust bag for dust-free operations
- Recommended for maximum results: 2.5 Ah battery
- Battery and charger sold separately

#### Technical Data

- |                         |                     |
|-------------------------|---------------------|
| • No load speed         | 6,500 RPM           |
| • Blade                 | 4" x 5/32" - Ø 7/8" |
| • Max. depth            | 3/4"                |
| • Tilt angle adjustment | 90°                 |
| • Product weight        | 4.84 lbs            |

**CLEAN WORKING AREA**

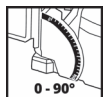

2.0 Ah	2.5 Ah	4.0 Ah	5.2 Ah	6.0 Ah	8.0 Ah
Up to 283 cuts	Up to 353 cuts	Up to 566 cuts	Up to 735 cuts	Up to 840 cuts	Up to 1132 cuts

Max. plunge cuts into softwood at size 10 biscuit

## Specialty Tools - Bare Tools

### 18V Cordless Rotary Tool Station

Article No. **4419370**

**TE-MT 18/34 Li**

UPC 7-72995-01965-6

**EXPERT**

**POWER X-CHANGE**



#### Features

- Electronic speed control for material-specific usage
- Lock button for easy tool change
- Flexible shaft with narrow pin for precise work
- Practical holder for flexible, 36" long shaft
- Rubber feet to secure station
- Accessory holder on the station for frequently used accessories
- Additional removable accessory box integrated in the housing
- Wall mounting for easy storage of the station
- 57-piece accessory kit for a wide range of jobs
- Recommended for maximum results: 2.5 Ah battery
- Battery and charger sold separately

#### Technical Data

- No load speed 5,000 - 34,000 RPM
- Length flexible shaft 36"
- Product weight 3.5 lbs

2.0 Ah	2.5 Ah	4.0 Ah	5.2 Ah	6.0 Ah	8.0 Ah
Up to 40 min	Up to 49 min	Up to 79 min	Up to 102 min	Up to 118 min	Up to 157 min

Max. operating time in idle mode



## Specialty Tools - Bare Tools

### 18V Cordless Heat Gun

Article No. **4520502**

**TE-HA 18 Li-Solo**

UPC 7-72995-01769-0

**EXPERT**

**POWER X-CHANGE**



#### Features

- High-power hot air gun with 2 temperature settings
- LED display for showing the selected temperature setting
- Overheating protection for safe operation
- Mechanical nozzle ejector for easy removal of nozzle attachments
- Swing-out metal hook for flexible work and storage
- Ergonomic softgrip surfaces
- Recommended battery for maximum results: 2.0 or 2.5 Ah battery
- Battery and charger sold separately

#### Technical Data

- Number of temperature settings 2
- Temperature at setting 1 350 °C
- Temperature at setting 2 550 °C
- Air flow rate at setting 1 & 2 200 L/min
- Product weight 1.76 lbs

#### Standard Accessories

- Reducer nozzle, wide jet nozzle, reflector nozzle

2.0 Ah	2.5 Ah	4.0 Ah	5.2 Ah	6.0 Ah	8.0 Ah
Up to 9 min	Up to 11 min	Up to 17 min	Up to 22 min	Up to 25 min	Up to 34 min

Max. operating time on setting 2



## Specialty Tools - Bare Tools

### 18V Cordless Full Size Glue Gun

Article No. **4522201**

**TE-CG 18 Li**

UPC 7-72995-01925-0

**EXPERT**

**POWER X-CHANGE**



#### Features

- Practical LED heat level indicator
- Operational for glueing after only 120 seconds of warm-up time
- Safe and comfortable handling thanks to the softgrip
- Automatic switch-off after 5 minutes of inactivity prevents glue overheating and other related safety risks
- Practical LED for optimum illumination of the working area
- Additional flat glueing nozzle for optimum usage in areas that are narrow or difficult to access
- Recommended for maximum results: 2.5 Ah battery
- Battery and charger sold separately

#### Technical Data

- Heat-up time 120 s
- Glue stick diameter 7/16" (0.45")
- Glue stick length 8"
- Product weight 1.76 lbs

#### Standard Accessories

- 5 glue sticks, 8" length
- Flat glueing nozzle

2.0 Ah	2.5 Ah	4.0 Ah	5.2 Ah	6.0 Ah	8.0 Ah
Up to 18 sticks	Up to 22 sticks	Up to 36 sticks	Up to 44 sticks	Up to 50 sticks	Up to 75 sticks

Max. 8" x 7/16" glue sticks



## Specialty Tools - Bare Tools

### 18V Cordless HVLP Handheld Paint Sprayer

Article No. **4260027**

**TC-SY 18/60 Li-Solo**

UPC 7-72995-01780-5

**CLASSIC**

**POWER X-CHANGE**



#### Features

- Hand-held system for small and medium-sized working areas
- Adapted for spraying of lacquers and glazes
- Removable spray head for cleaning
- Paint flow regulation for ideal adaptation of paint application
- Adjustable air cap for vertical, horizontal and round jets
- Ergonomic softgrip surfaces
- Practical hanging device for space-saving storage
- Recommended battery for maximum results: 2.5 Ah battery
- Battery and charger sold separately

#### Technical Data

• Flow rate	650 ml/min
• Max. viscosity	60 DIN-sec
• Tank volume	800 ml
• Product weight	2.6 lbs

#### Standard Accessories

- 2 nozzles (2 & 2.5 mm) for different viscosities of lacquer and glaze
- Purification brush for cleaning the uptake
- Purification needle for cleaning the spray nozzle
- 100 ml viscosity cup for examination of viscosity
- Lid for paint container
- 800 ml paint container with measurement scale



2.0 Ah	2.5 Ah	4.0 Ah	5.2 Ah	6.0 Ah	8.0 Ah
Up to 322 ft <sup>2</sup>	Up to 409 ft <sup>2</sup>	Up to 645 ft <sup>2</sup>	Up to 839 ft <sup>2</sup>	Up to 968 ft <sup>2</sup>	Up to 1291 ft <sup>2</sup>

Max. area coverage with paint viscosity of 60 DIN-sec

## Specialty Tools - Bare Tools

### 18V 10 oz. Cordless Caulk & Adhesive Gun

Article No. **4522251**

**TE-SG 18/10 Li**

UPC 7-72995-01956-4

**EXPERT**

**POWER X-CHANGE**



#### Features

- High dispensing force of up to 450 lbf
- Caulk & adhesive gun for 10.5 oz. (310 ml) tubes
- With bright LED for an optimum view of the work area
- Adjustable speed for various materials and quantities
- Dispensing speed controlled by adjusting wheel + pressure switch
- No dripping due to reversing mechanism
- Slimline design with ergonomic softgrip
- Recommended for maximum results: 2.5 Ah battery
- Battery and charger sold separately

#### Technical Data

• No load speed	15,000 RPM
• Dispensing force	450 lbf
• Max. feed rate	0.39"/s
• Min. feed rate	0.025"/s
• Speed settings	6
• Product weight	4.1 lbs



2.0 Ah	2.5 Ah	4.0 Ah	5.2 Ah	6.0 Ah	8.0 Ah
Up to 170 tubes	Up to 213 tubes	Up to 340 tubes	Up to 442 tubes	Up to 510 tubes	Up to 682 tubes

Max. number of 10.5 oz. caulking tubes



## 18V Cordless Handheld Vacuum

Article No. **2347124**

TE-VC 18 Li-Solo

UPC 7-72995-01776-8

**EXPERT**

**POWER X-CHANGE**



### Features

- Dust container with a volume of 540 ml (18.3 oz.)
- Can clean filters under running water
- Space-saving storage thanks to the integrated wall bracket
- Recommended battery for maximum results: 2.5 Ah battery
- Battery and charger sold separately

### Technical Data

- Max. suction power 17.5 CFM
- Dust container volume 540 ml (18.3 oz.)
- Product weight 2 lbs

### Standard Accessories

- Floor nozzle for hard floors and smooth surfaces
- Crevice nozzle for hard-to-reach areas
- Upholstery nozzle for cleaning upholstery and fabrics
- Extension tube (18") for cleaning floors
- Hanging bracket



2.0 Ah	2.5 Ah	4.0 Ah	5.2 Ah	6.0 Ah	8.0 Ah
Up to 16 min	Up to 18 min	Up to 31 min	Up to 40 min	Up to 46 min	Up to 62 min

Max. operating time in idle mode

## 18V Cordless Stick Vacuum Cleaner

Article No. **2347184**

TE-SV 18 Li

UPC 7-72995-01918-2

**EXPERT**

**POWER X-CHANGE**



### Features

- 4x spotlight LEDs for cleaning even in dark hard-to-reach areas
- Floor protecting and quiet working due to rubberized wheels
- Lightweight design for tireless working in and around the house
- 3-fold filter system results in high suction power and clean air
- Easy bag-free emptying protects the environment, saves costs and stands for hygiene by avoiding contact with dirt
- Suction power adjustment to every situation: ECO and BOOST mode
- Combines all advantages in one device: lightweight like a hand vacuum, and perfect handling for cleaning floors like a stick vacuum
- Motorized power brush is designed to remove dirt from any surface
- Comes with wall-holder to store both stick vacuum and accessories
- Flexible crevice nozzle for vacuuming hard-to-reach areas
- Recommended for maximum results: 2.5 Ah or 4.0 Ah battery
- Battery and charger sold separately

### Technical Data

- Max. suction power 21 CFM
- Dust container volume 0.16 Gallon (0.6L)
- Product weight 7.9 lbs

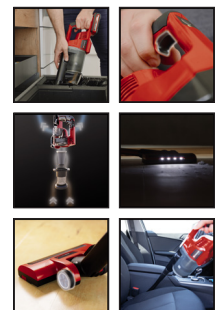

2.0 Ah	2.5 Ah	4.0 Ah	5.2 Ah	6.0 Ah	8.0 Ah
<sup>1</sup> Up to 25 min	Up to 31 min	Up to 50 min	Up to 65 min	Up to 80 min	Up to 100 min
<sup>2</sup> Up to 11 min	Up to 13 min	Up to 22 min	Up to 28 min	Up to 35 min	Up to 48 min

<sup>1</sup>: Max. running time in ECO mode — <sup>2</sup>: Max. running time in BOOST mode

### Optional Accessory

Article No. **2351268**

Replacement Washable Filter

UPC 7-72995-02039-3



## Vacuums / Wet-Dry Vacuums - Bare Tools

### 18V 2.6 Gallon (10L) Cordless Wet/Dry Vacuum

Article No. **2347165**

**TE-VC 18/10 Li**

UPC 7-72995-01777-5

**EXPERT**

**POWER X-CHANGE**



#### Features

- Easy to empty 2.6 Gallon (10L) tank to quick-release fasteners
- Ergonomic design and carry-handle for easy transport
- Highly versatile – wet and dry vacuuming possible
- Blow connection for blow-cleaning of hard-to-reach areas
- Included accessories can be stored directly on the equipment
- One-hand operation thanks to intelligent ON/OFF switch position
- Recommended battery for maximum results: 4.0 Ah battery
- Battery and charger sold separately

#### Technical Data

- |                               |                  |
|-------------------------------|------------------|
| • Max. suction power          | 42.4 CFM         |
| • Volume                      | 2.6 Gallon (10L) |
| • Suction hose length         | 2.3 to 6.6 ft.   |
| • Suction hose diameter       | 1-3/8"           |
| • Sound pressure level        | 72 dB            |
| • Sealed suction (water lift) | 33"              |
| • Product weight              | 6.8 lbs          |

#### Standard Accessories

- Extendible hose with a total length of 6.6 ft.
- 2-in-1 crevice/brush nozzle and 2-in-1 upholstery/universal nozzle
- Foam filter, filter bag and paper dust bag



#### Optional Accessories

Article No. **2351136** 5 pc. 10L Foam Filters Kit  
UPC 7-72995-01805-5

Article No. **2351261** 5 pc. 10L Dust Bags Kit  
UPC 7-72995-01814-7



2.0 Ah	2.5 Ah	4.0 Ah	5.2 Ah	6.0 Ah	8.0 Ah
Up to 10 min	Up to 12 min	Up to 21 min	Up to 26 min	Up to 30 min	Up to 42 min

Max. operating time in idle mode

## Vacuums / Wet-Dry Vacuums - Bare Tools

### 18V 5.3 Gallon (20L) Cordless Wet/Dry Vacuum

Article No. **2347137**

**TC-VC 18/20 Li S**

UPC 7-72995-01778-2

**CLASSIC**

**POWER X-CHANGE**



#### Features

- 5.3 Gallon (20L) stainless steel tank
- Blow connection for blow-cleaning hard-to-reach areas
- 4 castors for good mobility
- Practical accessories holder for clean stowage and operations
- Hose system with 1-3/8" diameter maintains high air and dirt flow
- Recommended battery for maximum results: 4.0 Ah battery
- Battery and charger sold separately

#### Technical Data

- |                               |                  |
|-------------------------------|------------------|
| • Max. suction power          | 53 CFM           |
| • Volume                      | 5.3 Gallon (20L) |
| • Suction hose length         | 4.9 ft.          |
| • Suction hose diameter       | 1-3/8"           |
| • Sound pressure level        | 72 dB            |
| • Sealed suction (water lift) | 33"              |
| • Product weight              | 7.9 lbs          |

#### Standard Accessories

- Plastic suction hose and three-part extension tube
- Big combination nozzle, crevice nozzle & upholstery nozzle
- Foam filter, pleated filter and paper dust bag

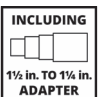

#### Optional Accessories

**2351137** 5 pc. 20L/30L Foam Filters Kit (UPC 7-72995-01807-9)

**2351168** 5 pc. 20L Dust Bags Kit (UPC 7-72995-01812-3)

**2351142** 1 pc. 20L/30L Fabric Filter (UPC 7-72995-01806-2)

**2351192** 5 pc. 20L High Efficiency Dust Bags Kit (UPC 7-72995-01809-3)

**2351118** 1 pc. Pleated Filter w/ Lid (UPC 7-72995-01811-6)

**2351236** 3 pc. Nozzle Kit (UPC 7-72995-01810-9)

2.0 Ah	2.5 Ah	4.0 Ah	5.2 Ah	6.0 Ah	8.0 Ah
Up to 10 min	Up to 11 min	Up to 20 min	Up to 25 min	Up to 32 min	Up to 40 min

Max. operating time in idle mode

## Vacuums / Wet-Dry Vacuums - Bare Tools

### 36V 8 Gallon (30L) Cordless Wet/Dry Vacuum

Article No. **2347141**

**TE-VC 36/30 Li-S**

UPC 7-72995-01779-9

**EXPERT**

**POWER X-CHANGE**



#### Features

- TWIN-PACK technology: 2 x 18V Power X-Change batteries required
- 2 speeds (ECO/BOOST) for optimal battery use
- High suction power with simultaneous wireless freedom
- 8 Gallon (30L) stainless steel tank
- Blow connection for blow-cleaning hard-to-reach areas
- 2 large wheels and 2 castors for better mobility
- Practical accessories holder for clean stowage and operations
- Water drain screw for draining water
- Telescopic stainless steel suction tube 1-3/8"
- Air regulator on the handle
- Recommended batteries for maximum results: 2 x 4.0 Ah batteries
- Batteries and charger sold separately

#### Technical Data

- Max. suction power 56 CFM
- Volume 8 Gallon (30L)
- Suction hose length 8.2 ft.
- Suction hose diameter 1-3/8"
- Sound pressure level 76 dB
- Sealed suction (water lift) Boost 59"
- Sealed suction (water lift) ECO 40"
- Product weight 6.6 lbs

#### Standard Accessories

- Heavy-duty 1-3/8" suction hose (8.2 ft.)
- Big comfort nozzle for carpets/smooth floors
- Foam filter, pleated filter and dust bag

**TWIN-PACK®**  
18V + 18V = 36V  
**TECHNOLOGY**



2x	2x	2x	2x	2x	2x
2.0 Ah	2.5 Ah	4.0 Ah	5.2 Ah	6.0 Ah	8.0 Ah
<sup>1</sup> Up to 8 min	Up to 10 min	Up to 16 min	Up to 21 min	Up to 24 min	Up to 32 min
<sup>2</sup> Up to 11 min	Up to 13 min	Up to 22 min	Up to 28 min	Up to 33 min	Up to 44 min

<sup>1</sup>: Max. running time in ECO mode — <sup>2</sup>: Max. running time in BOOST mode

#### Optional Accessories

- 2351137** 5 pc. 20L/30L Foam Filters Kit (UPC 7-72995-01807-9)
- 2351176** 5 pc. 30L Dust Bags Kit (UPC 7-72995-01813-0)
- 2351142** 1 pc. 20L/30L Fabric Filter (UPC 7-72995-01806-2)
- 2351196** 5 pc. 30L High Efficiency Dust Bags Kit (UPC 7-72995-01808-6)
- 2351118** 1 pc. Pleated Filter w/ Lid (UPC 7-72995-01811-6)
- 2351236** 3 pc. Nozzle Kit (UPC 7-72995-01810-9)

## Vacuums / Wet-Dry Vacuums - Bare Tools

### 18V 4 Gallon (15L) Cordless Ash Vacuum

Article No. **2361701**

**TE-AV 18/15 Li C**

UPC 7-72995-01919-9

**EXPERT**

**POWER X-CHANGE**



#### Features

- With filter cleaning system for restoring the suction power
- The 4 Gallon tank enables a long use
- Four castors for mobility
- Practical carrying handle for easy transport
- Convenient storage thanks to the hose rewind on the head
- Metal-reinforced suction hose and aluminum crevice nozzle
- Comes with a pleated filter
- Convert to blowing function by inserting hose in the air outlet
- Easy emptying of the container thanks to quick-release fasteners
- Recommended for maximum results: 2.5 Ah or 4.0 Ah battery
- Battery and charger sold separately

#### Technical Data

- Tank capacity 4 Gallon (15L)
- Suction hose length 4.7 ft.
- Suction hose diameter 1.375"
- Product weight 6.6 lbs



2x	2x	2x	2x	2x	2x
2.0 Ah	2.5 Ah	4.0 Ah	5.2 Ah	6.0 Ah	8.0 Ah
Up to 15 min	Up to 18 min	Up to 30 min	Up to 37 min	Up to 44 min	Up to 60 min

Max. operating time in idle mode



## Air Movement - Bare Tools

### 36V 1.6 Gallon (6L) Cordless Compact Air Compressor

Article No. **4020455**

**TE-AC 36/6/8 Li OF Set**

UPC 7-72995-01781-2

**EXPERT**

**POWER X-CHANGE**



#### Features

- TWIN-PACK technology: 2 x 18V Power X-Change batteries required
- Oil-free, service-free motor for low maintenance requirements
- Mobile, high-performance cordless compressor with a 1.6 Gallon (6L) tank
- Ergonomic design and handle for easy transport
- Applications up to 135 PSI can be set using the pressure reducer
- Pressure gauge & quick-release coupling for regulated pressure
- Vibration-damped feet for standing securely
- Safety valve protects user
- Drain cock enables user-friendly maintenance
- Recommended batteries for maximum results: 2 x 4.0 Ah batteries
- Batteries and charger sold separately

#### Technical Data

- |                           |                    |
|---------------------------|--------------------|
| • Motor speed             | 16,000 RPM         |
| • No load speed           | 3,200 RPM          |
| • Air flow                | 4.58 CFM           |
| • Output power            | 1.94 CFM @ 60 PSI  |
| • Output power            | 1.34 CFM @ 100 PSI |
| • Max. operating pressure | 135 PSI            |
| • Tank capacity           | 1.6 Gallon (6L)    |
| • No. of cylinders        | 1                  |
| • Product weight          | 21.34 lbs          |

**TWIN-PACK®**  
18V + 18V = 36V  
**TECHNOLOGY**



#### Standard Accessories

- 8 ft. high-quality air hose
- Blow-out gun, tire pressure gauge and 8-piece adapter set

	2.0 Ah	2.5 Ah	4.0 Ah	5.2 Ah	6.0 Ah	8.0 Ah
1	Up to 25 cycles	Up to 29 cycles	Up to 50 cycles	Up to 60 cycles	Up to 80 cycles	Up to 100 cycles
2	Up to 400 staples	Up to 435 staples	Up to 800 staples	Up to 900 staples	Up to 1320 staples	Up to 1600 staples

1: Tank inflation cycles per charge — 2: 1/2" Narrow crown staples per charge

## Air Movement - Bare Tools

### 18V Cordless Compact Blower

Article No. **3408005**

**TE-CB 18/180 Li**

UPC 7-72995-01772-0

**EXPERT**

**POWER X-CHANGE**



#### Features

- Low and high power settings
- Versatile for work site, workshop or garden
- Air flow up to 180 km/h
- Air flow setting 1: 130 km/h
- Air flow setting 2: 180 km/h
- Ergonomic softgrip surfaces
- Recommended battery for maximum results: 2.0 or 2.5 Ah battery
- Battery and charger sold separately

#### Technical Data

- |                        |                |
|------------------------|----------------|
| • No load speed (low)  | 1 - 11,500 RPM |
| • No load speed (high) | 2 - 15,500 RPM |
| • Max. air speed       | 180 km/h       |
| • Product weight       | 2 lbs          |



	2.0 Ah	2.5 Ah	4.0 Ah	5.2 Ah	6.0 Ah	8.0 Ah
	Up to 39 min	Up to 48 min	Up to 68 min	Up to 100 min	Up to 124 min	Up to 136 min

Max. operating time in idle mode

## 18V Cordless High Volume Power Inflator

Article No. **2070120**

CE-AP 18 Li

UPC 7-72995-01958-8

**EXPERT****POWER X-CHANGE**

### Features

- Ideal for inflating rafts, air mattresses and other leisure items
- 2 valve adapters for flexible application
- Enables fast filling with 23.66 CFM and a max. pressure of 0.76 PSI
- Deflate by simply changing the attachment to the deflation port
- Can also be used as a workshop blower for a quick cleaning
- Locking switch for fatigue-free work
- Comes with LED light for illumination in low-light conditions
- Ergonomic handle for increased operator comfort
- Recommended for maximum results: 2.5 Ah battery
- Battery and charger sold separately

### Technical Data

- |                           |           |
|---------------------------|-----------|
| • Max. operating pressure | 0.76 PSI  |
| • Max. delivery rate      | 23.66 CFM |
| • Product weight          | 0.88 lbs  |



2.0 Ah	2.5 Ah	4.0 Ah	5.2 Ah	6.0 Ah	8.0 Ah
Up to 65 min	Up to 81 min	Up to 130 min	Up to 169 min	Up to 195 min	Up to 260 min

Max. operating time in idle mode

## 18V Cordless High Pressure Inflator w/ Digital Gauge

Article No. **2071020**

CE-CC 18 Li

UPC 7-72995-01964-9

**EXPERT****POWER X-CHANGE**

### Features

- Ideal for inflating car tires, bicycle tires and sport balls
- Digital pressure indicator for quick and easy reading
- Selection either bar, PSI or kPa modes
- Easy adjustment of the pressure up to max. 160 PSI
- Automatic shut-off function when desired pressure is reached
- Manual inflating without pre-settings also possible
- Integrated storage of the 3-piece inflatable adapter set
- 23" pressure hose
- Ergonomic handle for increased operator comfort
- Recommended for maximum results: 2.5 Ah battery
- Battery and charger sold separately

### Technical Data

- |                           |          |
|---------------------------|----------|
| • Max. operating pressure | 160 PSI  |
| • Length pressure hose    | 23"      |
| • Product weight          | 1.76 lbs |



2.0 Ah	2.5 Ah	4.0 Ah	5.2 Ah	6.0 Ah	8.0 Ah
Up to 42 min	Up to 53 min	Up to 84 min	Up to 109 min	Up to 126 min	Up to 168 min

Max. operating time in idle mode

## 18V Dual Function Corded/Cordless Inflator/Deflator

Article No. **4020463****PRESSITO**

UPC 7-72995-01782-9

**EXPERT****POWER X-CHANGE**

### Features

- Hybrid function: for use with a power cable/rechargeable battery
- High-pressure pump for inflating car tires, cycle tires, balls
- Low-pressure pump for inflating air mattresses
- Low-pressure suction function for deflating air mattresses
- Easy-to-operate manual digital pressure indicator
- High-pressure pump with adjustable pressure settings up to 160 PSI
- With auto shutoff function when adjusted pressure is reached
- Integrated storage holder for the 3-piece inflation adapter set
- Recommended battery for maximum results: 4.0 Ah battery
- Battery and charger sold separately

### Technical Data

- Power supply 18V & 120V | 60 Hz
- Suction capacity high pressure pump 0.73 CFM
- Output power at 60 PSI (18V) 0.32 CFM
- Output power at 100 PSI (18V) 0.21 CFM
- Output power at 60 PSI (120V) 0.34 CFM
- Output power at 100 PSI (120V) 0.28 CFM
- Max. volumetric flow 13.3 CFM
- Max. operating pressure 160 PSI
- Hose lengths (low/high) 12.2" / 28"
- Product weight 4.62 lbs

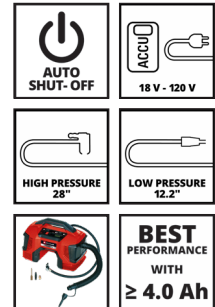

2.0 Ah	2.5 Ah	4.0 Ah	5.2 Ah	6.0 Ah	8.0 Ah
Up to 30 min	Up to 37 min	Up to 60 min	Up to 85 min	Up to 90 min	Up to 120 min

Max. operating time in idle mode

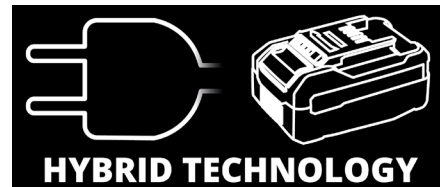

## 18V 7" Cordless Fan

Article No. **3408036****GE-CF 18/2200 Li**

UPC 7-72995-01953-3

**EXPERT****POWER X-CHANGE**

### Features

- Compact and portable cordless fan for indoor or outdoor use
- Variable adjustment of the fan head
- Numerous fastening options
- 3 speed settings for adjusting the air flow
- Recommended for maximum results: 2.5 Ah battery
- Battery and charger sold separately

### Technical Data

- Fan diameter 7"
- No load speed 1,200 / 1,700 / 2,200 RPM
- Max. air speed 15 km/h
- Swivel range 0 - 360°
- Product weight 2.54 lbs



2.0 Ah	2.5 Ah	4.0 Ah	5.2 Ah	6.0 Ah	8.0 Ah
Up to 7 hours	Up to 8.8 hours	Up to 14 hours	Up to 18 hours	Up to 21 hours	Up to 28 hours

Max. operating time in idle mode



## 18V Cordless LED Work Light

Article No. **4514135**

TC-CL 18 Li H

UPC 7-72995-02033-1

**CLASSIC****POWER X-CHANGE**

### Features

- High-quality LED of the company CREE Ltd.
- Practical metal hook
- Ergonomic handle with softgrip
- High flexibility thanks to a swiveling head
- Recommended for maximum results: 2.5 Ah battery
- Battery and charger sold separately

### Technical Data

- |                  |         |
|------------------|---------|
| • Number of LED  | 1       |
| • Max. lumens    | 280 lm  |
| • Light color    | 7,000 K |
| • Product weight | 0.5 lbs |



2.0 Ah	2.5 Ah	4.0 Ah	5.2 Ah	6.0 Ah	8.0 Ah
Up to 10 hours	Up to 12 hours	Up to 22 hours	Up to 32 hours	Up to 33 hours	Up to 44 hours

Max. operating time in idle mode

## 18V Cordless LED Spotlight

Article No. **4514146**

TE-CL 18/2500 LiAC

UPC 7-72995-01908-3

**EXPERT****POWER X-CHANGE**

### Features

- 7 bright LEDs with a total of 2,500 lumens
- Two brightness levels for ideal illumination
- 6,500K color temperature for a well-lit work area
- Slim-line and lightweight design for versatile use
- Ergonomic handle with softgrip
- Can be operated from a 12V cigarette lighter socket
- Can be fastened to a tripod thanks to the 1/4" tripod thread
- Fastening eyelet for flexible fastening and storage
- Recommended for maximum results: 2.5 Ah battery
- Battery and charger sold separately

### Technical Data

- |                   |           |
|-------------------|-----------|
| • Number of LED   | 7         |
| • Max. lumens     | 2,500 lm  |
| • Light color     | 6,500 K   |
| • Spotlight range | 2,100 ft. |
| • Product weight  | 1.3 lbs   |

### Standard Accessory

- 12V cigarette lighter socket adapter



	2.0 Ah	2.5 Ah	4.0 Ah	5.2 Ah	6.0 Ah	8.0 Ah
1	Up to 291 min	Up to 355 min	Up to 611 min	Up to 794 min	Up to 916 min	Up to 1222 min
2	Up to 85 min	Up to 111 min	Up to 183 min	Up to 238 min	Up to 274 min	Up to 366 min

1: Max. luminous period at 40% — 2: Max. luminous period at 100%

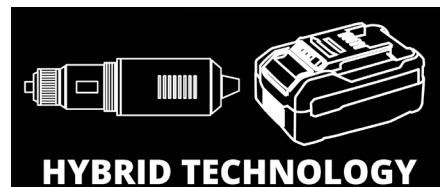
**HYBRID TECHNOLOGY**

## LED Lights - Bare Tools

### 18V 2000 Lumen Hybrid LED Work Light

Article No. **4514137**

**TE-CL 18/2000 LiAC**

UPC 7-72995-01909-0

**EXPERT**

**POWER X-CHANGE**



#### Features

- Optimum illumination thanks to high-performance LED
- High flexibility thanks to a swiveling lamp head
- Universal use thanks to numerous fastening options
- Hybrid function ensures permanent operational readiness
- Comes with 120V power adapter
- Recommended for maximum results: 2.5 Ah battery
- Battery and charger sold separately

#### Technical Data

- |                               |           |
|-------------------------------|-----------|
| • Power supply                | 18V/ 120V |
| • Number of LED               | 20        |
| • Max. lumens                 | 2,000 lm  |
| • Light color                 | 5,300 K   |
| • Number of brightness levels | 3         |
| • Product weight              | 3.5 lbs   |

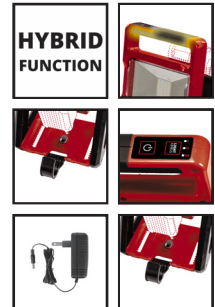

2.0 Ah	2.5 Ah	4.0 Ah	5.2 Ah	6.0 Ah	8.0 Ah
Up to 115 min	Up to 145 min	Up to 230 min	Up to 300 min	Up to 345 min	Up to 460 min

Max. operating time in idle mode

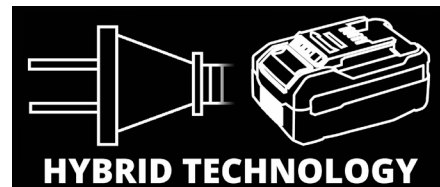

## Practical Accessory - Bare Tool

### 18V Cordless Bluetooth Speaker

Article No. **4514151**

**TC-SR 18 Li BT-Solo**

UPC 7-72995-01775-1

**CLASSIC**

**POWER X-CHANGE**



#### Features

- Easy connection with the device thanks to Bluetooth
- AUX connection for connecting an MP3 player, mobile phone, etc.
- USB connection for charging a mobile phone, tablet or MP3 player
- Intuitive control panel makes it easy to use
- Recommended for maximum results: 2.0 Ah or 2.5 Ah battery
- Battery and charger sold separately

#### Technical Data

- |                         |                   |
|-------------------------|-------------------|
| • Output voltage USB    | 5V                |
| • Output current USB    | 2A                |
| • Output power speakers | 2 x 3W            |
| • Max. volume           | 85 dB             |
| • Output frequency      | 0,12 kHz - 20 kHz |
| • Bluetooth version     | 5.0               |
| • Product weight        | 0.6 lbs           |



2.0 Ah	2.5 Ah	4.0 Ah	5.2 Ah	6.0 Ah	8.0 Ah
Up to 57 hours	Up to 72 hours	Up to 114 hours	Up to 148 hours	Up to 171 hours	Up to 228 hours

Max. operating time at 50%

## E-Cases

### E-Case S-F Small Tool Case

Article No. **4540022**

**E-Case S-F**

UPC 7-72995-01786-7



#### Features

- Locking system for connecting stacked cases, ensures easy storage and transport
- Scratch-free transport thanks to 2x foam inserts included
- Splash-proof design for safe storage and transport
- High-quality polypropylene ensures heat resistance, stiffness and impact resistance
- 2 x foldable, ergonomic handles for comfortable transportation
- Equipped with padlock hole to secure case

#### Technical Data

- |                      |                      |
|----------------------|----------------------|
| • Inside dimensions  | 16.3" x 10.7" x 3.7" |
| • Outside dimensions | 17.5" x 13" x 5.125" |
| • Max. payload       | 55 lbs               |
| • Product weight     | 3.74 lbs             |

#### Standard Accessory

- 2 x Foam inserts for bottom and lid



### E-Case L Large Rolling Tool Case

Article No. **4540023**

**E-Case L**

UPC 7-72995-01787-4



#### Features

- Locking system for connecting stacked cases ensures easy storage and transport
- High-quality polypropylene ensures heat resistance, stiffness and impact resistance
- Robust and durable construction allows a payload of up to 264 lbs
- Easy transport thanks to telescopic, extra-wide handle
- 6" large wheels enable comfortable rolling on any surface
- Padlock hole applicable as anti-theft device

#### Technical Data

- |                     |                            |
|---------------------|----------------------------|
| • Inside dimensions | 16.375" x 10.75" x 12.625" |
| • Max. payload      | 264 lbs                    |
| • Product weight    | 13.77 lbs                  |

#### Standard Accessories

- 1 x E-Case L
- 1 x Hand tool tray
- 1 x Label & 2 x spacer clips



### E-Case Tower Rolling Tool Case

Article No. **4540024**

**E-Case Tower**

UPC 7-72995-01788-1



#### Features

- Locking system for connecting stacked cases ensures easy storage and transport
- High-quality polypropylene ensures heat resistance, stiffness and impact resistance
- Robust and durable construction allows a payload of up to 264 lbs
- Easy transport thanks to telescopic, extra-wide handle
- 6" large wheels enable comfortable rolling on any surface
- Foldable, ergonomic handle for comfortable carrying up to 198 lbs
- Padlock lock applicable as anti-theft device

#### Technical Data

- |                                   |                            |
|-----------------------------------|----------------------------|
| • Inside dimensions of E-Case S-F | 16.3" x 10.7" x 3.7"       |
| • Inside dimensions of E-Case L   | 16.375" x 10.75" x 12.625" |
| • Max. payload                    | 264 lbs                    |
| • Product weight                  | 22.3 lbs                   |

#### Standard Accessories

- 1 x E-Case S-F comes with foam inlay (top and lid)
- 1 x E-Case S-C comes with compartments (2 x large, 3 x middle, 4 x small)
- 1 x E-Case L comes with tool tray
- 3 x Labels & 2 x spacer clips



### Optional Accessories

#### E-Case Compartments Kit

Article No. **4540025**

**E-Case Compartments Kit**

UPC 7-72995-01789-8



#### E-Case Perforated Foam Kit

Article No. **4540026**

**E-Case Perforated Foam**

UPC 7-72995-01790-4







***CORDLESS  
OUTDOOR POWER  
EQUIPMENT***





## Lawn Mower Kits with Batteries & Charger(s)

### 18V 13" Cordless Push Lawn Mower Kit - Brushless (w/ 4.0 Ah Battery and Charger)

Article No. **3413298**

**GE-CM 18/33 Li BL Kit**

UPC 7-72995-01970-0

**EXPERT**

**POWER X-CHANGE**



#### Features

- Brushless motor - more power and longer runtimes
- Battery capacity indicator with 3 LEDs
- Central cutting height adjustment, 5 levels
- Long folding handle for space-saving storage and transportation
- Height-adjustable long handle with 3 settings
- Integrated carry-handle for easy transport
- Fill level indicator on the grass collection bag
- Wide wheels with lawn-friendly operation
- High quality, blowmold plastic housing
- Recommended for lawn areas up to 2152 ft²
- Comes with 4.0 Ah battery and charger

#### Technical Data

- |                             |                               |
|-----------------------------|-------------------------------|
| • Battery                   | 18V   4.0 Ah   Li-Ion         |
| • Idle speed                | 3,400 RPM                     |
| • Cutting width             | 13"                           |
| • Cutting height adjustment | 5 Steps   1" - 2.5"   Central |
| • Collection bag capacity   | 8 Gallon (30L)                |
| • Wheel diameter (front)    | 6"                            |
| • Wheel diameter (rear)     | 7"                            |
| • Product weight            | 22 lbs                        |

#### Standard Accessories

- 1 x 4.0 Ah Power X-Change battery & charger

**PUREPOWER**  
BRUSHLESS



2.0 Ah	2.5 Ah	4.0 Ah	5.2 Ah	6.0 Ah	8.0 Ah
Up to 1076 ft²	Up to 1399 ft²	Up to 2152 ft²	Up to 3229 ft²	Up to 4305 ft²	Up to 5381 ft²

Max. workable area

#### Optional Accessory

Article No. **3405458**  
UPC 7-72992-02036-2

13" Replacement Lawn Mower Blade



## Lawn Mower Kits with Batteries & Charger(s)

### 36V 17" Cordless Push Lawn Mower Kit - Brushless (w/ 2 x 4.0 Ah Batteries and Charger)

Article No. **3413273**

**RASARRO 36/42 Li BL Kit**

UPC 7-72995-01846-8

**PROFESSIONAL**

**POWER X-CHANGE**



#### Features

- Brushless motor - more power and longer runtimes
- TWIN-PACK technology: 2 x 18V Power X-Change batteries
- Battery capacity indicator with 3 LEDs
- Central cutting height adjustment, 6 levels (1" - 3")
- Space saving storage thanks to foldable long handle
- Stable and lightweight aluminum-long handle
- 13.2 Gallon (50L) grass collection bag with top level indicator
- Integrated carry-handle for easy transport
- Comes with a mulching adapter
- Recommended for lawn areas up to 5920 ft²
- Comes with 2 x 4.0 Ah batteries and charger

#### Technical Data

- |                             |                              |
|-----------------------------|------------------------------|
| • Battery                   | 2 x 18V   4.0 Ah   Li-Ion    |
| • Idle speed                | 3,400 RPM                    |
| • Cutting width             | 17"                          |
| • Cutting height adjustment | 6 Levels   1" - 3"   Central |
| • Collection bag capacity   | 13.2 Gal. (50L)              |
| • Wheel diameter (front)    | 6"                           |
| • Wheel diameter (rear)     | 8-5/8"                       |
| • Product weight            | 37 lbs                       |

#### Standard Accessories

- 2 x 4.0 Ah Power X-Change batteries & dual port charger
- Mulching adapter

**PUREPOWER**  
BRUSHLESS

**TWIN-PACK®**  
18V + 18V = 36V  
TECHNOLOGY



2.0 Ah	2.5 Ah	4.0 Ah	5.2 Ah	6.0 Ah	8.0 Ah
Up to 3200 ft²	Up to 3800 ft²	Up to 5920 ft²	Up to 7800 ft²	Up to 9418 ft²	Up to 11,840 ft²

Max. workable area

#### Optional Accessory

Article No. **3405457**  
UPC 7-72992-01848-2

17" Replacement Lawn Mower Blade



## Lawn Mower Kits with Batteries & Charger(s)

### 36V 21" Cordless Self Propelled Lawn Mower Kit - Brushless (w/ 4 x 5.2 Ah Batteries and 2 Chargers)

Article No. **3413322**

GP-CM 36/52 S Li BL Kit

UPC 7-72995-01969-4

**PROFESSIONAL**

**POWER X-CHANGE**



#### Features

- Brushless motor - more power and longer runtimes
- DOUBLE-TWIN-PACK: 4 battery slots for twice the runtime
- LED battery charge indicator on the handle
- ECO mode for longer runtime
- 9-level central cutting height adjustment
- Rear wheel drive with variable speed adjustment
- Mulching function with mulching adapter
- 17.2 Gallon (65L) grass collection bag with fill level indicator
- LED light on the engine head to illuminate the mowing area
- 4-in-1 function: mowing, collecting, mulching and side discharge
- Recommended for lawn areas up to 12,915 ft<sup>2</sup>
- Comes with 4 x 5.2 Ah batteries & 2 x 3A Twin-Chargers

#### Technical Data

- Batteries 36V | 4 x 5.2Ah (18V) | Li-Ion
- Idle speed 3,000 RPM
- Cutting height adjustment 9 Levels | 1" - 3-1/8" | Central
- Collection bag capacity 17.2 Gallon (65L)
- Wheel diameter (front) 7-1/2"
- Wheel diameter (rear) 10-1/2"
- Product weight 62 lbs

#### Standard Accessories

- 4 x 5.2 Ah Power X-Change batteries & 2 x dual port chargers
- Mulching adapter & side ejector adapter

4x	4x	4x	4x	4x	4x
2.0 Ah	2.5 Ah	4.0 Ah	5.2 Ah	6.0 Ah	8.0 Ah
Up to 5920 ft <sup>2</sup>	Up to 6781 ft <sup>2</sup>	Up to 9687 ft <sup>2</sup>	Up to 12,915 ft <sup>2</sup>	Up to 15,069 ft <sup>2</sup>	Up to 17,222 ft <sup>2</sup>

Max. lawn area (ft<sup>2</sup>) per battery charge with 4 batteries

#### Optional Accessory

Article No. **3405981**

UPC 7-72992-02037-9

21" Replacement Lawn Mower Blade



**PUREPOWER**  
BRUSHLESS

**TWIN-PACK®**

18V + 18V = 36V

TECHNOLOGY



## String Trimmers - Kits & Bare Tools

### 18V 10" Cordless Telescopic Stringless Blade Trimmer Kit (w/ 2.0 Ah Battery and Charger)

Article No. **3411126**

GC-CT 18/24 Li-T Kit

UPC 7-72995-01864-2

**CLASSIC**

**POWER X-CHANGE**



20x

#### Features

- Safety guard and adjustable edge guide
- Adjustable telescopic long handle
- User-friendly two-hand operation thanks to additional handle
- Ergonomic softgrip surfaces
- Comes with 2.0 Ah battery and charger

#### Technical Data

- Revolutions of blade 8,500 RPM
- Cutting width of blade 9-1/2"
- Product weight 2.8 lbs

#### Standard Accessories

- 1 x 2.0 Ah Power X-Change battery & charger
- 20 Plastic blades

2.0 Ah	2.5 Ah	4.0 Ah	5.2 Ah	6.0 Ah	8.0 Ah
Up to 55 min	Up to 65 min	Up to 125 min	Up to 160 min	Up to 180 min	Up to 250 min

Max. operating time in idle mode

#### Optional Accessory

Article No. **3705727**

UPC 7-72992-01859-8

20 pc. Replacement Blades Kit





## String Trimmers - Kits & Bare Tools

### 18V 11" Cordless Telescopic String Trimmer

Article No. **3411245**

GE-CT 18/28 Li T

UPC 7-72995-01865-9

**EXPERT**

**POWER X-CHANGE**



#### Features

- Adjustable telescopic long handle
- Adjustable additional handle
- Motor head rotates 180° for vertical surfaces & lawn edges
- Motor head tilts at 3 settings for versatile working
- Edge guide protects flowers and trees against damage
- Includes line spool (16.4 ft.) with fully-automatic line feed
- Ergonomic softgrip surfaces
- Recommended for maximum results: 2.5 Ah battery
- Battery and charger sold separately

#### Technical Data

- |                         |             |
|-------------------------|-------------|
| • Revolutions of thread | 8,000 RPM   |
| • Cutting feature       | Single line |
| • Cutting width         | 11"         |
| • Thread diameter       | 0.065"      |
| • Thread length         | 16.4 ft.    |
| • Line feed             | Automatic   |
| • Product weight        | 4.4 lbs     |



2.0 Ah	2.5 Ah	4.0 Ah	5.2 Ah	6.0 Ah	8.0 Ah
Up to 45 min	Up to 55 min	Up to 85 min	Up to 95 min	Up to 115 min	Up to 120 min

Max. operating time in idle mode

#### Optional Accessory

Article No. **3405118**

16.4 ft. x 0.065" Trimmer Line Spool

UPC 7-72992-01856-7



## String Trimmers - Kits & Bare Tools

### 18V 12" Cordless Telescopic String Trimmer

Article No. **3411260**

GE-CT 18/30 Li T

UPC 7-72995-01866-6

**EXPERT**

**POWER X-CHANGE**



#### Features

- Adjustable telescopic long handle
- Adjustable additional handle for comfortable handling
- Motor head rotates 90° for vertical surfaces & lawn edges
- Comes with edging-wheel which enables precise edge trimming
- Motor head can be tilted at 3 settings
- Edge guide protects flowers and trees against damage
- Includes line spool (16.4 ft.) with bump-feed system
- Ergonomic softgrip surfaces
- Recommended for maximum results: 4.0 Ah battery
- Battery and charger sold separately

#### Technical Data

- |                          |             |
|--------------------------|-------------|
| • Revolutions of threads | 8,500 RPM   |
| • Cutting feature        | Single line |
| • Cutting width          | 12"         |
| • Thread diameter        | 0.065"      |
| • Thread length          | 16.4 ft.    |
| • Line feed              | Bump-Feed   |
| • Product weight         | 5 lbs       |



2.0 Ah	2.5 Ah	4.0 Ah	5.2 Ah	6.0 Ah	8.0 Ah
Up to 30 min	Up to 35 min	Up to 55 min	Up to 65 min	Up to 80 min	Up to 120 min

Max. operating time in idle mode

#### Optional Accessory

Article No. **3405119**

16.4 ft. x 0.065" Trimmer Line Spool

UPC 7-72992-01857-4



## String Trimmers - Kits & Bare Tools

### 36V 12" Cordless String Trimmer

Article No. **3411295**

**GE-CT 36/30 Li E**

UPC 7-72995-01867-3

**EXPERT**

**POWER X-CHANGE**



#### Features

- TWIN-PACK technology: 2 x 18V Power X-Change batteries required
- Front-Motor: Perfect power transmission and weight balance
- Adjustable additional handle
- Electronic speed control
- Long handle made of aluminum
- Split handle for easy transport and space-saving storage
- 26 ft. single line spool with automatic line feed system & shoulder strap included
- Safety guard and edge guide
- Wall bracket
- Ergonomic softgrip surfaces
- Recommended for maximum results: 2 x 4.0 Ah batteries
- Batteries and charger sold separately

#### Technical Data

- Revolutions of thread 9,000 RPM
- Cutting feature Single line
- Cutting width 12"
- Thread diameter 0.080"
- Thread length 26 ft.
- Line feed Automatic
- Product weight 6.8 lbs

**TWIN-PACK®**

18V + 18V = 36V

**TECHNOLOGY**



2.0 Ah	2.5 Ah	4.0 Ah	5.2 Ah	6.0 Ah	8.0 Ah
Up to 30 min	Up to 38 min	Up to 60 min	Up to 75 min	Up to 90 min	Up to 120 min

Max. operating time in idle mode

#### Optional Accessory

Article No. **3405097**

26 ft. x 0.080" Trimmer Line Spool

UPC 7-72992-01855-0



## Hedge Trimmers - Kits & Bare Tools

### 18V 20" Cordless Hedge Trimmer Kit (w/ 2.0 Ah Battery and Charger)

Article No. **3410709**

**GE-CH 1846 Li Kit**

UPC 7-72995-01849-9

**EXPERT**

**POWER X-CHANGE**



#### Features

- Blades are made of laser-cut and diamond-ground steel
- Ergonomic, small front handle with micro switch
- Metal gearing for a long life
- Cutting collector included
- Shock guard with wall mount
- Sturdy cutter guard for storage and transportation
- Comes with 2.0 Ah battery and charger

#### Technical Data

- Battery 18V | 2.0 Ah | Li-Ion
- Blade length 20-1/2"
- Space between teeth 9/16"
- Max. cutting diameter 0.43"
- Cutting speed 2,200 cuts/min
- Product weight 2.8 lbs

#### Standard Accessories

- 1 x 2.0 Ah Power X-Change battery & charger

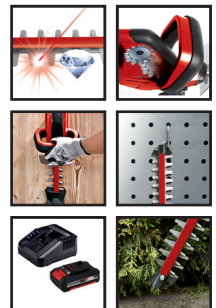

2.0 Ah	2.5 Ah	4.0 Ah	5.2 Ah	6.0 Ah	8.0 Ah
Up to 80 min	Up to 100 min	Up to 160 min	Up to 210 min	Up to 240 min	Up to 320 min

Max. operating time in idle mode

## Hedge Trimmers - Kits & Bare Tools

### 18V 24" Cordless Hedge Trimmer

Article No. **3410923**

**ARCURRA 18/55 Li**

UPC 7-72995-01842-0

**EXPERT**

**POWER X-CHANGE**



#### Features

- Blades are made of laser-cut and diamond-ground steel
- Ergonomic slim front handle with micro switch
- Metal gearing for a long life
- Cutting collector
- Aluminum cover over blades
- Ergonomic softgrip surfaces
- Shock guard with wall mount
- Sturdy cutter guard for storage and transportation
- Recommended for maximum results: 4.0 Ah battery
- Battery and charger sold separately

#### Technical Data

- |                         |                |
|-------------------------|----------------|
| • Blade length          | 24-1/2"        |
| • Space between teeth   | 3/4"           |
| • Max. cutting diameter | 0.6"           |
| • Cutting speed         | 2,400 cuts/min |
| • Product weight        | 6.27 lbs       |



2.0 Ah	2.5 Ah	4.0 Ah	5.2 Ah	6.0 Ah	8.0 Ah
Up to 45 min	Up to 53 min	Up to 90 min	Up to 110 min	Up to 135 min	Up to 180 min

Max. operating time in idle mode

## Hedge Trimmers - Kits & Bare Tools

### 36V 28" Cordless Hedge Trimmer

Article No. **3410963**

**GE-CH 36/65 Li**

UPC 7-72995-01930-4

**EXPERT**

**POWER X-CHANGE**



#### Features

- TWIN-PACK technology: 2 x 18V Power X-Change batteries required
- Blades are made of laser-cut and diamond-ground steel
- Ergonomic slim front handle with micro switch
- Pivoting rear handle
- Metal gearing for a long life
- Cutting collector
- Aluminum cover over cutters
- Safety guard with holder for wall mount
- Sturdy cutter guard for storage and transportation
- Recommended for maximum results: 2 x 4.0 Ah batteries
- Batteries and charger sold separately

#### Technical Data

- |                       |                |
|-----------------------|----------------|
| • Blade length        | 28.375"        |
| • Space between teeth | 1.18"          |
| • Max. cut diameter   | 0.7"           |
| • Cutting speed       | 2,700 cuts/min |
| • Product weight      | 8.8 lbs        |

**TWIN-PACK®**  
18V + 18V = 36 V  
TECHNOLOGY

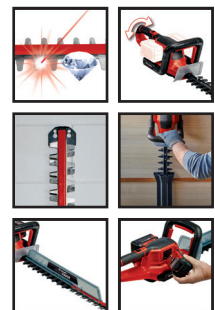

2.0 Ah	2.5 Ah	4.0 Ah	5.2 Ah	6.0 Ah	8.0 Ah
Up to 45 min	Up to 53 min	Up to 90 min	Up to 110 min	Up to 135 min	Up to 180 min

Max. operating time in idle mode



## Pole Hedge Trimmer - Bare Tool

### 18V 18" Cordless Pole Hedge Trimmer

Article No. **3410584**

GC-HH 18/45 Li

UPC 7-72995-01861-1

**CLASSIC**

**POWER X-CHANGE**



#### Features

- Motor head can be tilted
- Blade made of laser-cut and diamond-ground steel
- Metal gearing for long life
- Sturdy cutter guard for storage and transportation
- Shoulder strap
- Comes with extension pole (26.4" long)
- Recommended for maximum results: 4.0 Ah battery
- Battery and charger sold separately

#### Technical Data

- Blade length 18"
- Space between teeth 3/4"
- Max. cutting diameter 0.70"
- Cutting speed 1,400 cuts/min
- Product weight 7 lbs



2.0 Ah	2.5 Ah	4.0 Ah	5.2 Ah	6.0 Ah	8.0 Ah
Up to 30 min	Up to 35 min	Up to 60 min	Up to 70 min	Up to 80 min	Up to 112 min

Max. operating time in idle mode

## Pole Chain Saw - Bare Tool

### 18V 8" Cordless Pole Chain Saw

Article No. **3410583**

GC-LC 18/20 Li

UPC 7-72995-01860-4

**CLASSIC**

**POWER X-CHANGE**



#### Features

- OREGON bar and chain
- Metal gearing for long life
- Comes with extension pole (26.4" long)
- Automatic chain lubrication
- Sturdy cutter guard for storage and transportation
- Shoulder strap
- Recommended for maximum results: 4.0 Ah battery
- Battery and charger sold separately

#### Technical Data

- Bar length 8"
- Cutting speed 18.4 ft/sec (5.5 m/sec)
- Chain pitch | teeth 3/8" | 33
- Chain thickness 0.043"
- Oil tank capacity 70 ml
- Product weight 7.9 lbs



2.0 Ah	2.5 Ah	4.0 Ah	5.2 Ah	6.0 Ah	8.0 Ah
Up to 50 pcs	Up to 65 pcs	Up to 100 pcs	Up to 130 pcs	Up to 155 pcs	Up to 200 pcs

Max. cuts in 2-3/4" x 2-3/4" timber

#### Optional Accessory

Article No. **90PX033X**  
UPC 7-72992-02030-0

8" Replacement Chain



## Multi-Attachment Tools - Bare Tools

### 18V 2-in-1 Cordless Telescopic Combo 8" Pole Chain Saw/18" Hedge Trimmer

Article No. **3410789**

**GE-HC 18 Li T**

UPC 7-72995-01852-9

**EXPERT**

**POWER X-CHANGE**



#### Features

- Attachment can pivot 90° for effortless horizontal cuts
- Tilting motor head with 7 settings
- Tilting main handle with 4 settings
- Adjustable telescopic aluminum handle (6 ft. - 9 ft.-7" chain saw / 6 ft. - 10 ft. hedge trimmer)
- Adjustable additional handle with quick fastener
- Metal gearing for a long life
- OREGON quality blade and chain
- Tool-free chain tensioning and chain change
- Blade made of laser-cut and diamond-grinded steel
- Shoulder strap
- Oil tank with automatic chain lubrication
- Recommended for maximum results: 4.0 Ah battery
- Battery and charger sold separately

#### Technical Data

- Chain saw bar length 8"
- Chain saw cutting speed 12.14 ft/sec (3.7 m/sec)
- Hedge trimmer blade length 17.7"
- Spacing between teeth 5/8"
- Cutting speed 1,700 cuts/min
- Product weight 8.6 lbs



2.0 Ah	2.5 Ah	4.0 Ah	5.2 Ah	6.0 Ah	8.0 Ah
Up to 40 pcs	Up to 48 pcs	Up to 75 pcs	Up to 100 pcs	Up to 120 pcs	Up to 150 pcs

Chain saw attachment - Max. cuts in 2-3/4" x 2-3/4" timber

2.0 Ah	2.5 Ah	4.0 Ah	5.2 Ah	6.0 Ah	8.0 Ah
Up to 30 min	Up to 35 min	Up to 60 min	Up to 75 min	Up to 80 min	Up to 120 min

Hedge trimmer attachment - Max. operating time in idle mode

## Multi-Attachment Tools - Bare Tools

### 36V 4-in-1 Cordless Combo - Brushless 13" String Trimmer/10" Brush Cutter/8" Pole Chain Saw/20" Hedge Trimmer

Article No. **3411325**

**GE-LM 36/4in1 Li BL**

UPC 7-72995-01853-6

**EXPERT**

**POWER X-CHANGE**



#### Features

- Brushless motor - more power and longer runtimes
- TWIN-PACK technology: 2 x 18V Power X-Change batteries
- Hedge trimmer cutting head tilts with 7 settings
- OREGON quality blade and chain
- Oil tank for automatic chain lubrication
- Single line spool with bump feed system
- High-quality 3-tooth brush cutter blade
- Comes with extension pole (26.4") for higher hedges and branches
- Recommended for maximum results: 2 x 4.0 Ah batteries
- Batteries and charger sold separately

#### Technical Data

- Hedge trimmer blade length 20"
- Tooth spacing 0.95"
- Chain saw bar length 8"
- Cutting speed 32.8 ft/sec (10 m/sec)
- String trimmer cutting diameter 13"
- Brush cutter blade cutting diameter 10"
- Product weight 8.8 lbs

#### Optional Accessories

Article No. **3405084**  
UPC 7-72995-01944-1  
Article No. **3405097**  
UPC 7-72992-01855-0

10" Replacement Brush Cutter Blade

26 ft. x 0.080" Trimmer Line Spool

**PUREPOWER**  
BRUSHLESS

**TWIN-PACK®**  
18V + 18V = 36V  
TECHNOLOGY



2x 2.0 Ah	2x 2.5 Ah	2x 4.0 Ah	2x 5.2 Ah	2x 6.0 Ah	2x 8.0 Ah
1 Up to 80 pcs	Up to 100 pcs	Up to 160 pcs	Up to 200 pcs	Up to 240 pcs	Up to 320 pcs
2 Up to 34 min	Up to 41 min	Up to 68 min	Up to 86 min	Up to 108 min	Up to 136 min

1- Max. cutting capacity per battery charge (Chain Saw- 2-3/4" x 2-3/4" square timber)  
2- Max. running time per battery charge (Brush Cutter)

2x 2.0 Ah	2x 2.5 Ah	2x 4.0 Ah	2x 5.2 Ah	2x 6.0 Ah	2x 8.0 Ah
3 Up to 27 min	Up to 33 min	Up to 54 min	Up to 66 min	Up to 88 min	Up to 108 min
4 Up to 28 min	Up to 33 min	Up to 56 min	Up to 66 min	Up to 80 min	Up to 112 min

3- Max. running time per battery charge (String Trimmer)  
4- Max. running time per battery charge (Hedge Trimmer)

## Pruning / Shrub Shears - Bare Tools

### 18V Cordless Pruning Shear

Article No. **3408304**

**GE-LS 18 Li**

UPC 7-72995-01844-4

**EXPERT**

**POWER X-CHANGE**



#### Features

- For powerful cutting of branches with a thickness up to 1.1"
- High-quality bypass blades for efficient cutting work
- Belt clip for optimum carrying comfort
- Safety switch for safety while using the shear
- Sliding switch for closing/opening the blade
- Sturdy plastic cover for the blade for safe storage
- Effortless and easy change of blade
- Ergonomic softgrip surface
- Recommended for maximum results: 2.5 Ah battery
- Battery and charger sold separately

#### Technical Data

- Max. cutting capacity (softwood) 1.1"
- Max. cutting capacity (hardwood) 0.6"
- Product weight 1.9 lbs



2.0 Ah	2.5 Ah	4.0 Ah	5.2 Ah	6.0 Ah	8.0 Ah
Up to 1426 pcs	Up to 1783 pcs	Up to 2852 pcs	Up to 3708 pcs	Up to 4278 pcs	Up to 5704 pcs

Max. cuts in 5/8" round dry beech wood

## Pruning / Shrub Shears - Bare Tools

### 18V 2-in-1 Cordless Telescopic Grass Shear & Hedge Trimmer (with Walking Stick)

Article No. **3410314**

**GE-CG 18/100 Li T**

UPC 7-72995-01840-6

**EXPERT**

**POWER X-CHANGE**



#### Features

- Grass shear blade used for perfect cutting result on edges
- Hedge trimmer blade for hedge and bush care
- Easy blade change without tools
- Laser-cut and diamond grinded blades
- Adjustable telescopic handle
- Ergonomic softgrip surfaces
- Recommended for maximum results: 2.5 Ah battery
- Battery and charger sold separately

#### Technical Data

- Cutting length (Grass Shear) 4"
- Cutting length (Hedge Trimmer) 7.9"
- Hedge trimmer cutting diameter 5/16"
- Product weight 3.42 lbs



2.0 Ah	2.5 Ah	4.0 Ah	5.2 Ah	6.0 Ah	8.0 Ah
Up to 240 min	Up to 300 min	Up to 480 min	Up to 650 min	Up to 720 min	Up to 960 min

Max. operating time in idle mode



## Chain Saws- Kits & Bare Tools

### 18V 6" Cordless Compact Pruning Chain Saw - Brushless

Article No. **4600035**

**GE-PS 18/15 Li BL**

UPC 7-72995-01975-5

**EXPERT**

**POWER X-CHANGE**



#### Features

- Brushless motor – more power and longer runtimes
- Excellent for pruning, trimming and shaping trees and shrubs or cutting squared timber
- Low vibration due to highly efficient motor
- High quality bar/chain set for high cutting performance
- Slim shaped handle for ergonomic working
- Tool-free change of chain and bar
- Safe use thanks to hand guard and folding chain cover
- Slim and lightweight design for ergonomic work
- Hex. key on device for tensioning the chain
- Comes with measuring help for manual chain lubrication and protective bar cover for storing the chain saw
- Recommended for maximum results: 4.0 Ah battery
- Battery and charger sold separately

#### Technical Data

- |                   |                   |
|-------------------|-------------------|
| • Bar length      | 6"                |
| • Cutting speed   | 189 IPS (4.8 m/s) |
| • Chain pitch     | 0.3"              |
| • Chain thickness | 0.039"            |
| • Product weight  | 2.4 lbs           |



2.0 Ah	2.5 Ah	4.0 Ah	5.2 Ah	6.0 Ah	8.0 Ah
Up to 127 pcs	Up to 158 pcs	Up to 254 pcs	Up to 329 pcs	Up to 380 pcs	Up to 506 pcs

Max. pcs. when cutting 2" round soft wood

#### Optional Accessories

Article No. **4500183**  
UPC 7-72995-02041-6

6" Replacement Bar

Article No. **4500184**  
UPC 7-72995-02042-3

6" Replacement Saw Chain



## Chain Saws- Kits & Bare Tools

### 18V 8" Top Handle Cordless Pruning Chain Saw - Brushless

Article No. **4600030**

**FORTEXXA 18/20 TH Li BL**

UPC 7-72995-01878-9

**PROFESSIONAL**

**POWER X-CHANGE**



#### Features

- Brushless motor - more power and longer runtimes
- OREGON quality bar and chain
- Tool-free chain tensioning and changing
- Kickback protection with chain brake
- Ergonomic softgrip surfaces
- Large oil filler opening
- Automatic chain lubrication
- Chain catcher
- Tip guard
- Recommendation for optimum results: 4.0 Ah battery
- Battery and charger sold separately

#### Technical Data

- |                       |                 |
|-----------------------|-----------------|
| • Bar length          | 8"              |
| • Cutting speed       | 276 IPS (7 m/s) |
| • Chain pitch / teeth | 3/8" / 33       |
| • Chain thickness     | 0.043"          |
| • Oil capacity        | 75 ml           |
| • Product weight      | 5.5 lbs         |



2.0 Ah	2.5 Ah	4.0 Ah	5.2 Ah	6.0 Ah	8.0 Ah
Up to 80 pcs	Up to 100 pcs	Up to 160 pcs	Up to 200 pcs	Up to 240 pcs	Up to 320 pcs

Max. cuts (2-3/4" x 2-3/4")

#### Optional Accessory

Article No. **90PX033X**  
UPC 7-72995-02030-0

8" Replacement Saw Chain



## Chain Saws - Kits & Bare Tools

### 18V 10" Cordless Chain Saw Kit (w/ 4.0 Ah Battery & Charger)

Article No. **4501786**

GE-LC 18/25-1 Li Kit

UPC 7-72995-01880-2

**EXPERT**

**POWER X-CHANGE**



#### Features

- OREGON quality bar and chain
- Tool-free chain tensioning and changing
- Ergonomic handle
- Metal stop claw
- Big oil filler opening
- Automatic chain lubrication
- Chain catch bolt
- Comes with 4.0 Ah battery and charger

#### Technical Data

- Battery 18V | 4.0 Ah | Li-Ion
- Bar length 10"
- Cutting speed 177 IPS (4.5 m/s)
- Chain pitch / teeth 3/8" / 40
- Chain thickness 0.043"
- Oil capacity 200 ml
- Product weight 6.4 lbs

#### Standard Accessories

- 1 x 4.0 Ah Power X-Change battery & charger



2.0 Ah	2.5 Ah	4.0 Ah	5.2 Ah	6.0 Ah	8.0 Ah
Up to 80 pcs	Up to 85 pcs	Up to 130 pcs	Up to 180 pcs	Up to 200 pcs	Up to 320 pcs

Max. cuts (2-3/4" x 2-3/4")

#### Optional Accessory

Article No. **90PX040X**  
UPC 7-72995-02031-7

10" Replacement Saw Chain



## Chain Saws- Kits & Bare Tools

### 18V 12" Cordless Chain Saw - Brushless

Article No. **4600015**

FORTEXXA 18/30

UPC 7-72995-01929-8

**EXPERT**

**POWER X-CHANGE**



#### Features

- Brushless motor – more power and longer runtimes
- OREGON quality bar and chain
- Adjustable chain speed
- Switch between max. power and Eco-Mode
- Tool-free chain tensioning and changing
- Kickback protection with chain brake
- Ergonomic handle with softgrip
- Metal stop claw
- Large oil filler opening
- Automatic chain lubrication
- Chain catcher
- Recommendation for maximum results: 4.0 Ah battery
- Battery and charger sold separately

#### Technical Data

- Bar length 12"
- Cutting speed 350.4 IPS (8.9 m/s)
- Chain pitch / teeth 3/8" / 45
- Chain thickness 0.043"
- Oil capacity 160 ml
- Product weight 9 lbs

**PUREPOWER**  
BRUSHLESS



2.0 Ah	2.5 Ah	4.0 Ah	5.2 Ah	6.0 Ah	8.0 Ah
Up to 1 70 pcs 2 78 pcs	Up to 88 pcs 98 pcs	Up to 140 pcs 156 pcs	Up to 182 pcs 203 pcs	Up to 210 pcs 234 pcs	Up to 280 pcs 312 pcs

1: Max. cuts 2-3/4" x 2-3/4" (MAX mode) — 2: Max. cuts 2-3/4" x 2-3/4" (ECO mode)

#### Optional Accessory

Article No. **90PX045X**  
UPC 7-72995-02134-5

12" Replacement Saw Chain



## Chain Saws - Kits & Bare Tools

### 36V 14" Cordless Chain Saw - Brushless

Article No. **4501781**

**GE-LC 36/35 Li BL**

UPC 7-72995-01879-6

**PROFESSIONAL**

**POWER X-CHANGE**



#### Features

- Brushless motor – more power and longer runtimes
- TWIN-PACK technology: 2 x 18V Power X-Change batteries required
- High-quality chain and bar from OREGON
- Tool-free chain tensioning and changing
- Kickback protection with chain brake
- Ergonomic softgrip surfaces
- Sturdy stop claws made of metal
- Big filler opening
- Automatic chain lubrication
- Chain catch bolt
- Recommended for maximum results: 2 x 4.0 Ah batteries
- Batteries and charger sold separately

#### Technical Data

- Bar length 14"
- Chain cutting speed 590.6 IPS (15 m/s)
- Chain pitch/teeth 3/8" / 52
- Chain thickness 0.043"
- Oil tank capacity 115 ml
- Product weight 9 lbs

**PUREPOWER**  
BRUSHLESS

**TWIN-PACK®**

18V + 18V = 36V

**TECHNOLOGY**



2.0 Ah	2.5 Ah	4.0 Ah	5.2 Ah	6.0 Ah	8.0 Ah
Up to 160 pcs	Up to 200 pcs	Up to 320 pcs	Up to 420 pcs	Up to 480 pcs	Up to 640 pcs

Max. cuts (2-3/4" x 2-3/4")

#### Optional Accessory

Article No. **90PX052X**  
UPC 7-72995-02032-4

14" Replacement Saw Chain



## Leaf Blowers/Vacuums/Mulchers - Kits & Bare Tools

### 18V 100 CFM Cordless Leaf Blower Kit (w/ 2.0 Ah Battery & Charger)

Article No. **3433543**

**GC-CL 18/1 Li E Kit**

UPC 7-72995-01851-2

**CLASSIC**

**POWER X-CHANGE**



#### Features

- Electronic speed control
- Softgrip for user-friendly operation
- Small and easy to handle
- Low weight
- Strong blow-air velocity of 250 km/h
- Comes with 2.0 Ah battery and charger

#### Technical Data

- Battery 18V | 2.0 Ah | Li-Ion
- Max. air volume 100 CFM
- Max. air speed 250 km/h
- No load speed 1,400 - 12,000 RPM
- Speed levels 6
- Product weight 2.8 lbs

#### Standard Accessories

- 1 x 2.0 Ah Power X-Change battery & charger



2.0 Ah	2.5 Ah	4.0 Ah	5.2 Ah	6.0 Ah	8.0 Ah
Up to 14-240 min	Up to 16-300 min	Up to 26-480 min	Up to 40-660 min	Up to 42-720 min	Up to 52-960 min

Max. operating time in ECO/BOOST mode



## 18V 395 CFM Cordless Leaf Blower - Brushless

Article No. **3433556**

GP-LB 18/200 Li BL

UPC 7-72995-01845-1

**PROFESSIONAL**

**POWER X-CHANGE**

### Features

- Brushless motor - more power and longer runtimes
- Electronic speed control with practical LED display
- Turbo switch included - for maximum blowing power
- Axial impeller technology - optimum performance
- Tool-free mountable / removable blower tube
- Balance handle with softgrip for ergonomic operation
- Integrated wall holder for easy storage
- Robust metal ring for long lifetime
- Recommended for maximum results: 4.0Ah battery
- Battery and charger sold separately

### Technical Data

- Max. air volume 395 CFM
- Max. air speed 200 km/h
- No load speed 13,000 - 18,000 RPM
- Product weight 5.7 lbs



2.0 Ah	2.5 Ah	4.0 Ah	5.2 Ah	6.0 Ah	8.0 Ah
Up to 5-13 min	Up to 8-15 min	Up to 15-27 min	Up to 18-33 min	Up to 20-37 min	Up to 30-54 min

Max. operating time in idle mode and turbo mode

## 36V 480 CFM Cordless Leaf Blower - Brushless

Article No. **3433617**

GP-LB 36/210 Li E BL

UPC 7-72995-01963-2

**PROFESSIONAL**

**POWER X-CHANGE**

### Features

- Brushless motor - more power and longer runtimes
- TWIN-PACK technology: 2 x 18V Power X-Change batteries required
- Turbo Boost button for maximum blowing volume
- Electronic speed control
- Metal ring at the end of the tube
- Built-in wall hanger for easy storage
- Comes with shoulder strap
- Recommended for maximum results: 2 x 4.0 Ah batteries
- Batteries and charger sold separately

### Technical Data

- Max. air volume 480 CFM
- Max. air speed 210 km/h
- No load speed 10,000 - 22,300 RPM
- Speed levels 6
- Product weight 5.5 lbs



2.0 Ah	2.5 Ah	4.0 Ah	5.2 Ah	6.0 Ah	8.0 Ah
Up to 55 min	Up to 63 min	Up to 116 min	Up to 138 min	Up to 165 min	Up to 232 min

Max. operating time in idle mode

## Leaf Blowers/Vacuums/Mulchers - Kits & Bare Tools

### 18V 3-in-1 300 CFM Cordless Leaf Blower/Vacuum/Mulcher - Brushless

Article No. **3433647**

**VENTURRO 18/210**

UPC 7-72995-01959-5

**EXPERT**

**POWER X-CHANGE**



#### Features

- Brushless motor - more power and longer runtimes
- Tool-free change from blowing and suction function
- Electronic speed control
- Large long-lasting quality collection bag with inspection window
- Collection bag assembly via clever quick fastening system
- Integrated shredding function includes additional metal knife
- Comes with additional handle and comfortable shoulder strap
- Softgrip for non-slip and convenient work
- Guide wheels for better weight relief
- Integrated wall holder for easy storage
- Removable tube for space-saving storage
- High blowing air speed up to 210 km/h
- Strong suction power up to 300 CFM
- Recommended for maximum results: 4.0 Ah battery
- Battery and charger sold separately

#### Technical Data

• Max. suction power	300 CFM
• Max. blowing power	106 CFM
• Max. air speed	210 km/h
• No load speed	8,000 - 14,000 RPM
• Shredding rate	10:1
• Collection bag volume	10 Gallon (38L)
• Product weight	6.6 lbs

**PUREPOWER**  
BRUSHLESS



2.0 Ah	2.5 Ah	4.0 Ah	5.2 Ah	6.0 Ah	8.0 Ah
Up to 10-14 min 24-15 min	Up to 5-18 min 5-19 min	Up to 9-30 min 9-32 min	Up to 11-42 min 13-40 min	Up to 15-45 min 14-48 min	Up to 18-60 min 18-64 min

1: Max. time- Vacuuming leaves — 2: Max. time- Blowing leaves

## Leaf Blowers/Vacuums/Mulchers - Kits & Bare Tools

### 36V 3-in-1 435 CFM Cordless Leaf Blower/Vacuum/Mulcher - Brushless

Article No. **3433645**

**VENTURRO 36/240 Li BL**

UPC 7-72995-01843-7

**PROFESSIONAL**

**POWER X-CHANGE**



#### Features

- Brushless motor - more power and longer runtimes
- TWIN-PACK technology: 2 x 18V Power X-Change batteries required
- Tool-free changeover from blowing and suction function
- Electronic speed control with LED display and turbo mode
- Large long-lasting quality collection bag with window for level inspection
- Fastening of the collection bag via clever quick fastening system
- Integrated shredding function
- Cleaning flap with safety switch for effortless cleaning
- Additional handle and comfortable shoulder strap
- Soft grip surfaces for non-slip and comfortable work
- Integrated wall holder for easy storage
- Removable tube for space-saving storage
- High blowing air speed up to 240 km/h
- Strong suction power up to 435 CFM
- Battery recommendation for best results: 2 x 4.0 Ah batteries
- Batteries and charger sold separately

#### Technical Data

• Max. suction power	435 CFM
• Max. blowing power	106 CFM
• Max. air speed	240 km/h
• No load speed	8,000 - 15,000 RPM
• Shredding rate	10:1
• Collection bag volume	10 Gallon (38L)
• Product weight	8.8 lbs

**PUREPOWER**  
BRUSHLESS

**TWIN-PACK®**  
18V + 18V = 36V  
TECHNOLOGY



2.0 Ah	2.5 Ah	4.0 Ah	5.2 Ah	6.0 Ah	8.0 Ah
Up to 19-23 min 29-25 min	Up to 10-27 min 10-28 min	Up to 17-46 min 18-49 min	Up to 21-56 min 21-58 min	Up to 27-70 min 28-74 min	Up to 34-92 min 36-98 min

1: Max. time- Vacuuming leaves — 2: Max. time- Blowing leaves

## Chipper Shredder - Bare Tool

### 36V Cordless Chipper Shredder

Article No. **3430730**

**REDAXXO 36/25**

UPC 7-72995-01972-4

**EXPERT**

**POWER X-CHANGE**



#### Features

- TWIN-PACK technology: 2 x 18V Power X-Change batteries required
- Hinged, transparent battery cover for protection
- Perfectly suited for shredding wood and garden waste quickly and reliably
- For shredding hard, dry wood up to max. 1" and fresh, moist cuttings
- 3 turning knives made of special steel for effective work
- Generous funnel opening
- Motor with circuit breaker
- Swing-down funnel with safety interlock
- Robust chassis with wheels
- High-quality shredding collection bag with 14.5 Gallon (55L) volume
- Hooks for securing the shredding collection bag
- Practical transport handle
- Comes with paddle and paddle holder on device for storage
- Recommended for maximum results: 2 x 4.0 Ah batteries
- Batteries and charger sold separately

#### Technical Data

- Max. branch diameter 1"
- Number of turning blades 3 pcs.
- Collection bag capacity 14.5 Gallon (55L)
- Product weight 22.9 lbs

**TWIN-PACK®**  
18V + 18V = 36V  
**TECHNOLOGY**



2.0 Ah	2.5 Ah	4.0 Ah	5.2 Ah	6.0 Ah	8.0 Ah
Up to 20 min	Up to 25 min	Up to 40 min	Up to 52 min	Up to 60 min	Up to 80 min

Max. operating time in idle mode

#### Optional Accessory

Article No. **3405935** 3 pc. 2" Chipper Shredder Replacement Blades Kit  
UPC 7-72995-02040-9



## Tiller/Cultivator - Bare Tool

### 36V 12" Cordless Tiller/Cultivator

Article No. **3431205**

**GE-CR 30 Li**

UPC 7-72995-01934-2

**EXPERT**

**POWER X-CHANGE**



#### Features

- TWIN-PACK technology: 2 x 18V Power X-Change batteries required
- Two-point safety switch
- Ergonomic folding handle
- Robust cultivator blades
- Height-adjustable wheels for easy transportation
- Recommended for maximum results: 2 x 4.0 Ah batteries
- Batteries and charger sold separately

#### Technical Data

- Working width 12"
- Working depth 8"
- Number of blades 4
- Diameter of blades 8.625"
- Product weight 26 lbs

**TWIN-PACK®**  
18V + 18V = 36V  
**TECHNOLOGY**



2.0 Ah	2.5 Ah	4.0 Ah	5.2 Ah	6.0 Ah	8.0 Ah
Up to 20 min	Up to 21 min	Up to 35 min	Up to 50 min	Up to 60 min	Up to 70 min

Max. operating time in idle mode



Auger - Bare Tool

18V 6" Cordless Auger - Brushless

Article No. **3437015**  
GP-EA 18/150 Li BL  
UPC 7-72995-01868-0

PROFESSIONAL POWER X-CHANGE



Features

- Brushless motor: more power and longer runtimes
- Metal frame - maximum stability and torsional stiffness
- 3 different modes: counterclockwise, clockwise: ECO & HIGH POWER
- Earth auger (31-1/2" length / 6" diameter) included
- Durable and robust gearbox integrated in aluminum housing
- Double handle with softgrip
- Recommended for maximum results: 4.0 Ah battery
- Battery and charger sold separately

Technical Data

- |                            |          |
|----------------------------|----------|
| • Max. speed               | 125 RPM  |
| • Earth auger bit diameter | 6"       |
| • Earth auger bit length   | 31-1/2"  |
| • Product weight           | 13.2 lbs |

2.0 Ah	2.5 Ah	4.0 Ah	5.2 Ah	6.0 Ah	8.0 Ah
Up to 15 holes	Up to 20 holes	Up to 40 holes	Up to 50 holes	Up to 60 holes	Up to 80 holes

Drilling in soft ground- 15-3/4" deep



Optional Accessories

Article No. **3437016** 4-3/4" Earth Auger Bit  
UPC 7-72995-01869-1



Article No. **3437017** 5" Mortar Mixer  
UPC 7-72995-01870-3



Article No. **3437018** 39-3/8" Auger Shaft Extension  
UPC 7-72995-01871-0



Article No. **3437019** 8" Ice Auger Bit  
UPC 7-72995-01872-4



## Seed, Fertilizer / Salt Spreaders - Bare Tools

### 18V Cordless Universal Spreader

Article No. **3415411**

**GE-US 18 Li**

UPC 7-72995-01933-5

**EXPERT**

**POWER X-CHANGE**



#### Features

- Electronic speed control with 6 steps
- Flow rate adjustment with 8 steps
- 1 Gallon (3.8L) fill volume
- Ergonomic and safe handling due to softgrip
- Individual adjustable spreading width (max. 16.4 ft)
- Easily spread fertilizer, lawn seeds or driveway salt
- Recommended for maximum results: 2.0 Ah or 2.5 Ah battery
- Battery and charger sold separately

#### Technical Data

- |                              |                          |
|------------------------------|--------------------------|
| • Fill volume                | 1 Gallon (3.8L)          |
| • Spreading width adjustment | 7.2 - 16.4 ft.           |
| • Speed control              | 6 steps (max. 1,800 RPM) |
| • Flow rate adjustment       | 8 steps                  |
| • Recommended area           | 8,600 ft <sup>2</sup>    |
| • Product weight             | 2.7 lbs                  |

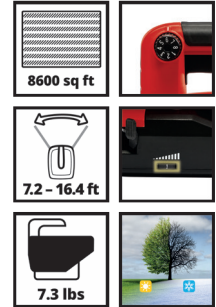

<b>2.0 Ah</b>	<b>2.5 Ah</b>	<b>4.0 Ah</b>	<b>5.2 Ah</b>	<b>6.0 Ah</b>	<b>8.0 Ah</b>
Up to <b>3</b> hours	Up to <b>4</b> hours	Up to <b>7</b> hours	Up to <b>9</b> hours	Up to <b>10</b> hours	Up to <b>14</b> hours

Max. operating time in idle mode

## Seed, Fertilizer / Salt Spreaders - Bare Tools

### 18V Cordless Multi-Purpose Spreader

Article No. **3415440**

**GE-SR 18/22 Li**

UPC 7-72995-01971-7

**EXPERT**

**POWER X-CHANGE**



#### Features

- 6-stage electronic speed control
- 6-stage ergonomic flow rate adjustment knob
- 6 Gallon (23L) fill tank capacity
- Ergonomically shaped handle for fatigue-free work
- Individually adjustable spread width
- Spread fertilizer, grass seed and even driveway salt
- Ergonomic and secure handling thanks to softgrip
- Recommended for maximum results: 4.0 Ah battery
- Battery and charger sold separately

#### Technical Data

- |                              |                          |
|------------------------------|--------------------------|
| • Fill Volume   Bulkweight   | 6 Gallons (23L)   66 lbs |
| • Spreading speed adjustment | 6 steps                  |
| • Flow rate adjustment       | 6 steps                  |
| • No load speed              | 300 - 700 RPM            |
| • Product weight             | 18.3 lbs                 |

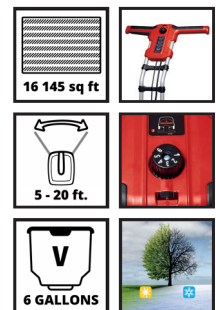

<b>2.0 Ah</b>	<b>2.5 Ah</b>	<b>4.0 Ah</b>	<b>5.2 Ah</b>	<b>6.0 Ah</b>	<b>8.0 Ah</b>
Up to <b>4</b> hours	Up to <b>5</b> hours	Up to <b>8</b> hours	Up to <b>10</b> hours	Up to <b>11</b> hours	Up to <b>15</b> hours

Max. operating time in idle mode

## Chemical/Pressure Sprayers - Bare Tools

### 18V Cordless 2 Gallon (7.5L) Chemical Sprayer

Article No. **3425221**

GE-WS 18/75 Li

UPC 7-72995-01833-8

**EXPERT**

**POWER X-CHANGE**



#### Features

- Automatic pump, no manual pressure build-up required
- Transparent tank with scale for checking the level
- Adjustable brass nozzle
- Telescopic lance made of stainless steel
- Battery cover provides protection against water
- Spray lance with lockable operating button
- Padded shoulder strap for tireless working
- Use: Pesticides/fertilizers/weed killers
- Recommended for maximum results: 4.0 Ah battery
- Battery and charger sold separately

#### Technical Data

- |                      |                             |
|----------------------|-----------------------------|
| • Tank capacity      | 2 Gallon (7.5L)             |
| • Tank volume        | 8.2L                        |
| • Max. pump pressure | 36 PSI (2.5 bars)           |
| • Flow rate          | 8 - 16 Gal./h (30 - 60 L/h) |
| • Hose length        | 55"                         |
| • Product weight     | 6.6 lbs                     |



2.0 Ah	2.5 Ah	4.0 Ah	5.2 Ah	6.0 Ah	8.0 Ah
Up to 6 hours	Up to 7.5 hours	Up to 12 hours	Up to 16 hours	Up to 20 hours	Up to 24 hours

*Max. operating time in idle mode*

#### Optional Accessory

Article No. **3425207** Replacement 2 Gallon (7.5L) Tank  
UPC 7-72995-01834-5



## Chemical/Pressure Sprayers - Bare Tools

### 18V Cordless 4 Gallon (15L) Backpack Pressure Sprayer

Article No. **3425231**

GE-WS 18/150 Li

UPC 7-72995-01951-9

**EXPERT**

**POWER X-CHANGE**



#### Features

- Automatic pump, no manual pressure build-up required
- Transparent tank with scale for checking the level
- Individually adjustable brass nozzle
- Spray lance made of stainless steel, with lockable operating button
- Battery cover provides protection against water
- Large opening for easy filling up
- Padded carrying straps for tireless working
- Use: Pesticides/fertilizers/weed killers
- Recommended for maximum results: 4.0 Ah battery
- Battery and charger sold separately

#### Technical Data

- |                         |                |
|-------------------------|----------------|
| • Tank capacity         | 4 Gallon (15L) |
| • Max. pump pressure    | 65 PSI         |
| • Flow rate (min - max) | 54 - 102 L/h   |
| • Length pressure hose  | 4.6 ft.        |
| • Product weight        | 9.7 lbs        |



2.0 Ah	2.5 Ah	4.0 Ah	5.2 Ah	6.0 Ah	8.0 Ah
Up to 2.5 hours	Up to 3.5 hours	Up to 5 hours	Up to 7 hours	Up to 8.5 hours	Up to 10 hours

*Max. operating time in idle mode*



## Water Hose Reel - Bare Tool

### 18V 5/8" x 100 ft. Cordless Water Hose Reel

Article No. **4173779**

**GE-HR 18/30 Li**

UPC 7-72995-01973-1

**EXPERT**

**POWER X-CHANGE**



#### Features

- Hose winding at the touch of a button: Effortless, no more dirty hands
- 2-in-1 device: Wall-mounted hose reel and mobile/transport trolley hose reel (sold separately) – Hose reel can be wall mounted or installed on the optional mobile/transport trolley (4173780)
- Additional side handle recesses facilitate lifting or transporting
- Practical wall mount includes dowels and stainless steel screws for fastening to the house wall
- Drum can be swivelled by up to 180°, this enables watering without folding the hose at any angle
- Automatic motor stop thanks to adjustable stopper ball
- Internal hose guiding mechanism ensures even retraction
- Practical maintenance flap: easily access the inside of the hose reel and replace the garden hose quickly
- Residual water drainage in the hose reel
- UV and splash-proof housing withstands all weather conditions
- Comes with 5 ft. connection hose and adapter with aquastop and 3 connectors (1/2", 3/4", 1")
- Comes with UV-resistant 100 ft. garden hose with stopper ball, adapter with aquastop and garden sprayer (point and cone jet)
- Recommended for maximum results: 4.0 Ah battery
- Battery and charger sold separately



#### Technical Data

- |                            |         |
|----------------------------|---------|
| • Length garden hose       | 100 ft. |
| • Diameter garden hose     | 5/8"    |
| • Length connecting hose   | 5 ft.   |
| • Diameter connecting hose | 5/8"    |
| • Product weight           | 24 lbs  |

2.0 Ah	2.5 Ah	4.0 Ah	5.2 Ah	6.0 Ah	8.0 Ah
Up to 33 times	Up to 42 times	Up to 66 times	Up to 86 times	Up to 100 times	Up to 132 times

Max. number of rewinds without water in water hose

## Garden Hose Reel - Accessory

### Mobile Hose Reel Trolley & Garden Cart

Article No. **4173780**

**HOSE\_REEL\_MOBILE\_CART**

UPC 7-72995-01974-8



#### Features

- Tool-free mounting of hose reel for mobile use
- Maximum load capacity of 110 lbs
- Large 6-3/4" wheels made of high-quality plastic
- Wide cargo surface of 11" x 13-3/8" for versatility of use
- Can also be used for transporting potted plants or crates
- Comes with 5/8" x 5 ft. extension hose with double nipple, 20 Gallon (75L) garden waste bag and 2 ground stakes for anchoring the trolley on the lawn

#### Technical Data

- |                    |                 |
|--------------------|-----------------|
| • Max. weight      | 110 lbs         |
| • Loading surface  | 11" x 13.4"     |
| • Extension hose   | 5/8" x 5 ft.    |
| • Garden waste bag | 20 Gallon (75L) |
| • Product weight   | 10.5 lbs        |

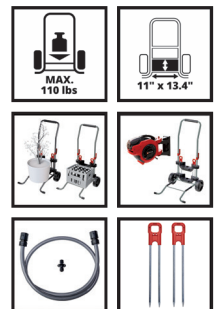

## Pressure Washer - Bare Tool

# 18V 348 PSI 1.0 GPM Cordless Pressure Washer

Article No. **4140145**

**HYPRESSO 18/24 Li**

UPC 7-72995-01927-4

**EXPERT**

**POWER X-CHANGE**



## Features

- Handy, light and compact for convenient cleaning
- Fast cleaning of lightly soiled surfaces with 1.0 GPM
- Spray gun with pressure regulation for cleaning and watering
- Adjustable 4 jet nozzle
- Comes with spray lance extension for better reach, detergent bottle for thorough cleaning, 16 ft. suction hose for water extraction from buckets, lakes, etc., water filter to protect the pump, storage bag for storage of accessories and battery protector
- Recommended for maximum results: 2.5 Ah or 4.0 Ah battery
- Battery and charger sold separately

## Technical Data

- Max. pressure 348 PSI
- Max. flow per minute 1.0 GPM
- Max. water temperature 40°C
- Max. water inlet pressure 72.5 PSI
- Product weight 4 lbs



2.0 Ah	2.5 Ah	4.0 Ah	5.2 Ah	6.0 Ah	8.0 Ah
Up to 1 13 min 2 7 min	Up to 15 min 8 min	Up to 27 min 15 min	Up to 35 min 18 min	Up to 45 min 23 min	Up to 55 min 30 min

1: Max. time in ECO mode — 2: Max. time in BOOST mode

## Water / Garden Pump - Bare Tool

# 36V Cordless Water Pump

Article No. **4180403**

**AQUINNA 36/30 Li**

UPC 7-72995-01835-2

**EXPERT**

**POWER X-CHANGE**



## Features

- TWIN-PACK technology: 2 x 18V Power X-Change batteries required
- Water filling screw
- Frost protection due to water drain screw
- Thermal protection
- ON/OFF switch
- 2 speed, 2-step ECO/BOOST switch (ECO up to 90% longer runtime)
- High quality mechanical sealing
- Comes with high quality brass discharge side adaptor (1" female 3/4" 11.5 GHT)
- Recommended for maximum results: 2 x 4.0 Ah batteries
- Batteries and charger sold separately

## Technical Data

- Max. delivery capacity 792 Gal./h (3000 L/h)
- Max. delivery height 55.7/85.3 ft.
- Max. delivery pressure 24.7/37.7 PSI
- Max. total head 26.2 ft.
- Connection intake side 1-1/4" ET (1.65")
- Connection discharge side 1" IT (1.31")
- Product weight 7.2 lbs

**TWIN-PACK®**  
18V + 18V 36 V  
TECHNOLOGY



2.0 Ah	2.5 Ah	4.0 Ah	5.2 Ah	6.0 Ah	8.0 Ah
Up to 35 min	Up to 47 min	Up to 70 min	Up to 85 min	Up to 100 min	Up to 140 min

Max. operating time in idle mode

## Optional Accessory

Article No. **4173642** 23 ft. Replacement Suction Hose  
UPC 7-72995-01836-9



## Power X-Change Batteries

### 2.0 Ah 18V Power X-Change Battery

Article No. **4511480**

18V 2.0Ah Power X-Change

UPC 7-72995-01791-1



### 2 x 4.0 Ah 18V Power X-Change Battery

Article No. **4511603**

PXC Twinpack 4.0 Ah

UPC 7-72995-01794-2



### 2.5 Ah 18V Power X-Change Battery

Article No. **4511903**

18V 2.5Ah Power X-Change

UPC 7-72995-01873-4



### 4.0 - 6.0 Ah 18V Power X-Change Battery

Article No. **4511904**

18V 4-6 Multi-Ah PXC

UPC 7-72995-01993-5



### 4.0 Ah 18V Power X-Change Battery

Article No. **4511481**

18V 4.0Ah Power X-Change

UPC 7-72995-02034-8



### 5.0 - 8.0 Ah 18V Power X-Change Battery

Article No. **4511609**

18V 5-8 Multi-Ah PXC

UPC 7-72995-01966-3



### 5.2 Ah 18V Power X-Change Battery

Article No. **4511499**

18V 5.2Ah Power X-Change

UPC 7-72995-01792-8



## Power X-Change Chargers

### 18V 30 min PXC Single Port Charger

Article No. **4512080**

18V 3A PXC Fast Charger

UPC 7-72995-01795-9



### 18V Power X-Boostcharger

Article No. **4512156**

PXC BOOSTCHARGER 8A

UPC 7-72995-01955-7



### 18V 30 min PXC Dual Port Charger

Article No. **4512090**

PXC Dual Port F.Charger

UPC 7-72995-01796-6



### 18V 2 x 2 PXC 4 Port Fast Charger

Article No. **4512122**

2x2 Power X-Quatrocharger 4A

UPC 7-72995-01954-0



## Power X-Change Battery & Charger Starter Kits

### 2.5 Ah 18V PXC Battery & Charger Starter Kit

Article No. **4512131**

18V 2.5Ah PXC Starter Kit

UPC 7-72995-01797-3



### 4.0 Ah 18V PXC Battery & Charger Starter Kit

Article No. **4512132**

18V 4.0Ah PXC Starter Kit

UPC 7-72995-01798-0



### 2 x 4.0 Ah 18V PXC Battery & Charger Starter Kit

Article No. **4512133**

2x 4.0Ah & DualPort Kit

UPC 7-72995-01839-0



## Power X-Change Battery Accessories

### 18V USB Battery Adaptor

Article No. **4514142**

TE-CP 18 Li USB

UPC 7-72995-01785-0



### Einhell PXC Battery Wall Mounts

Article No. **4514156**

PXC Battery Wall Mount

UPC 7-72995-01837-6







**EINHELL IS PARTNER OF THE  
MERCEDES-AMG PETRONAS F1 TEAM.**



Head Office  
700 rue Meloche, Dorval, Quebec H9P 2Y4  
Tel: (514) 636-5464 | Fax: (514) 636-5474



Official Tool Expert  
**AMG  
PETRONAS**  
FORMULA ONE TEAM

